



**CERTIFICATE OF COMPLIANCE**  
(Pursuant to Section 53 of the *Environmental Management Act*)

**THIS IS TO CERTIFY** that as of the date indicated below, the site identified in Schedule A of this Certificate of Compliance has been satisfactorily remediated to meet the applicable Contaminated Sites Regulation remediation standards and criteria.

This Certificate of Compliance is qualified by the requirements and conditions specified in Schedule B.

The substances for which remediation has been satisfactorily completed and for which this Certificate of Compliance is valid are listed in Schedule C.

I have issued this Certificate of Compliance based on a review of relevant information including the documents listed in Schedule D. I, however, make no representation or warranty as to the accuracy or completeness of that information.

A Director may rescind this Certificate of Compliance if requirements and conditions imposed in the Certificate of Compliance are not complied with or any fees payable under Part 4 of the Act or regulations are outstanding.

This Certificate of Compliance should not be construed as an assurance that there are no hazards present at the site.

2017-12-20  
Date Issued

  
Alan W. McCammon  
For Director, *Environmental Management Act*

## Schedule A

The site covered by this Certificate of Compliance is located at 1728 Gilmore Avenue, Burnaby, British Columbia, which is more particularly known and described as:

Lot 2 District Lot 120 Group 1 New Westminster District Plan EPP59106  
PID: 029-825-750

The approximate centre of the site using the NAD (North American Datum) 1983 convention is:

Latitude: 49° 16' 07.30"  
Longitude: 123° 00' 48.10"

2017-12-20  
Date Issued

  
Alan W. McCammon  
For Director, *Environmental Management Act*

### Site Plan, Burnaby, BC

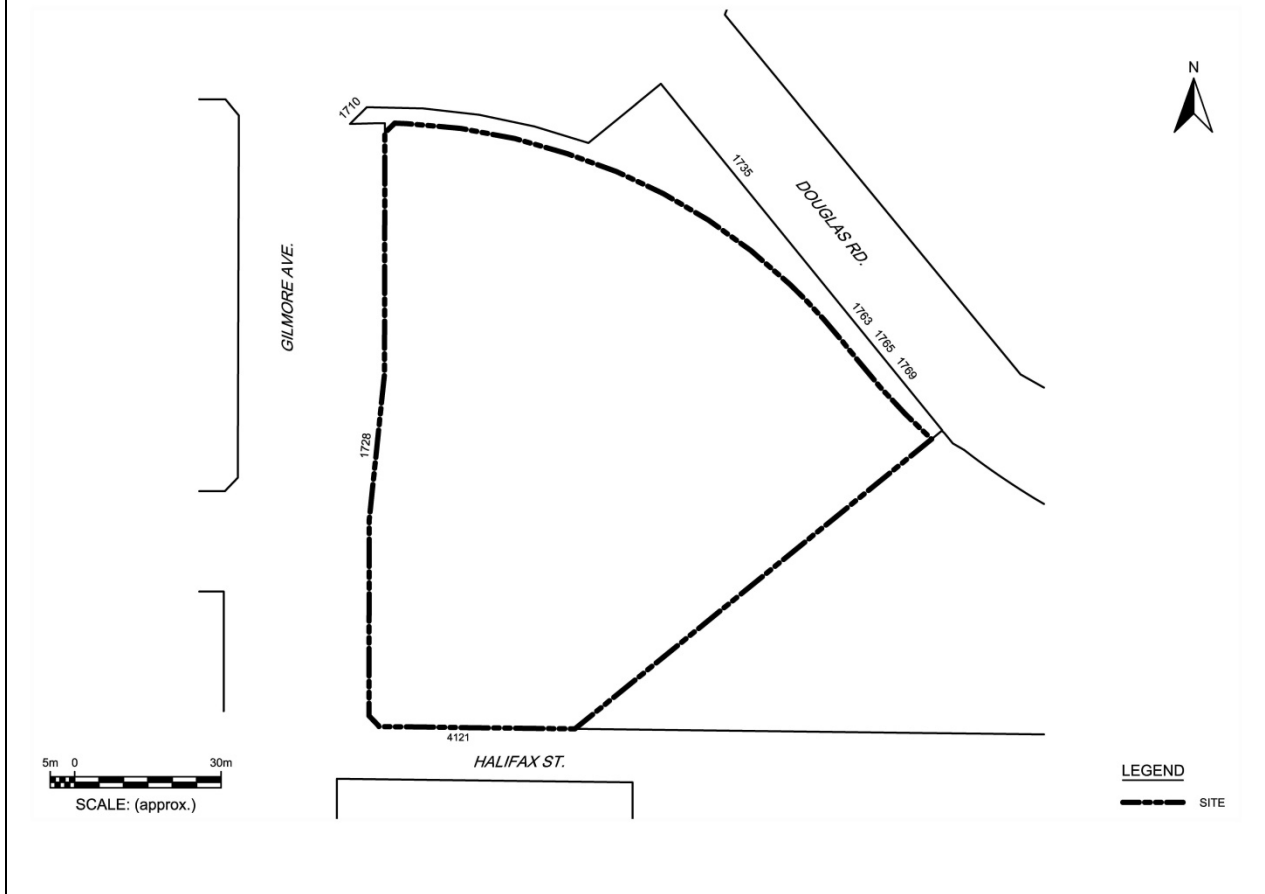

### Location Map, Burnaby, BC

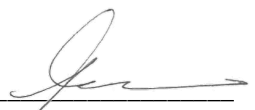

2017-12-20  
Date Issued

  
Alan W. McCammon  
For Director, Environmental Management Act

## Schedule B

### Requirements and Conditions

1. Any changes in land, vapour, or water uses must be promptly identified by the responsible persons in a written submission to the Director. An application for an amendment or new Certificate of Compliance may be necessary. The uses to which this condition applies are described in Schedule C and in the site investigation documents listed in Schedule D.

The documents listed in Schedule D indicate that vapour attenuation factors were applied to meet Contaminated Sites Regulation numerical standards at the site. These vapour attenuation factors were selected based on assumptions about the structures, locations and depths of buildings existing or expected at the site. These assumptions include the following:

- (a) Groundwater will not be in contact with the parkade foundation slab.

Any inconsistencies that arise between the structures, locations and depths of proposed or constructed buildings at the site and the range of structures, locations and depths of buildings assumed in the selection of vapour attenuation factors in the documents listed in Schedule D must be promptly identified by the responsible person<s> in a written submission to the Director. An application for an amendment or new Certificate of Compliance may be necessary.

2017-12-20  
Date Issued

  
Alan W. McCammon  
For Director, *Environmental Management Act*

## Schedule C

### Substances and Uses

#### *Substances remediated in soil for residential land soil use:*

To meet numerical remediation standards:

- Cadmium;
- Benzene; and
- VPHs, LEPHs and HEPHs.

#### *Substances remediated in water for freshwater aquatic life water use:*

To meet numerical remediation standards:

- Cadmium and cobalt.

#### *Substances remediated in water for drinking water use:*

To meet numerical remediation standards:

- Magnesium and sodium.

2017-12-20  
Date Issued

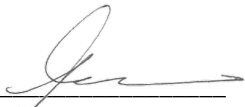
  
Alan W. McCammon  
For Director, *Environmental Management Act*

## Schedule D

### Documents

*Summary of Site Condition, 1728 Gilmore Avenue, Burnaby, BC, Michael Geraghty, Approved Professional, Keystone Environmental Ltd., September 27, 2017;*

*Report of Findings – Stage 1 Preliminary Site Investigation Update, Detailed Site Investigation and Confirmation of Remediation, 1710 and 1728 Gilmore Avenue, Burnaby, BC, Keystone Environmental Ltd., September 2017;*

*Geotechnical Investigation Report: Proposed Aviara Phase 2 Development, 1735-1769 Douglas Road, Burnaby, BC, GeoPacific Consultants Ltd., April 2013;*

*Report of Findings – Phase II Environmental Site Assessment – 1710 Gilmore Avenue, 1735 and 1763 Douglas Road, Burnaby, BC, Keystone Environmental Ltd., March 2013;*

*Report of Findings – Phase I Environmental Site Assessment – 1710 Gilmore Avenue, 1735 and 1763 Douglas Road, Burnaby, BC Keystone Environmental Ltd., September 2012;*

*Groundwater Sampling Program & Environmental Liability Estimate – 1763 Douglas Road, Burnaby, BC, Keystone Environmental Ltd., November 2011;*

*Report of Findings – Phase I Environmental Site Assessment – 1763 Douglas Road, Burnaby, BC, Keystone Environmental Ltd., October 2011; and*

*Report of Findings – Preliminary Site Investigation – Stage 1 – 1680 and 1710 Gilmore Avenue, Burnaby, BC, Keystone Environmental Ltd., April 2008.*

2017-12-20  
Date Issued

  
Alan W. McCammon  
For Director, *Environmental Management Act*