



CERTIFICATE OF COMPLIANCE

(Pursuant to Section 53 of the *Environmental Management Act*)

THIS IS TO CERTIFY that as of the date indicated below, the site identified in Schedule A of this Certificate of Compliance has been satisfactorily remediated to meet the applicable Contaminated Sites Regulation remediation standards and criteria.

This Certificate of Compliance is qualified by the requirements and conditions specified in Schedule B.

The substances for which remediation has been satisfactorily completed and for which this Certificate of Compliance is valid are listed in Schedule C.

I have issued this Certificate of Compliance based on a review of relevant information including the documents listed in Schedule D. I, however, make no representation or warranty as to the accuracy or completeness of that information.

A Director may rescind this Certificate of Compliance if requirements and conditions imposed in the Certificate of Compliance are not complied with or any fees payable under Part 4 of the Act or regulations are outstanding.

This Certificate of Compliance should not be construed as an assurance that there are no hazards present at the site.

2017-12-20
Date Issued

Alan W. McCammon
For Director, *Environmental Management Act*

Schedule A

The site covered by this Certificate of Compliance is located at 2330 & 2334 Clarke Street, Port Moody, British Columbia which is more particularly known and described as:

LOT 50 EXCEPT: PART ON STATUTORY RIGHT OF WAY PLAN 908, BLOCK 1
DISTRICT LOT 202, GROUP 1, NEW WESTMINSTER DISTRICT PLAN 55
PID: 011-454-610

EAST 11 FEET, LOT 49, BLOCK 1, DISTRICT LOT 202, GROUP 1, NEW
WESTMINSTER DISTRICT PLAN 55, EXCEPT PLAN 190
PID: 011-454-628

WEST 55 FEET 6 INCHES LOT 51 EXCEPT: PART ON STATUTORY RIGHT OF
WAY PLAN 908, BLOCK 1, DISTRICT LOT 202, GROUP 1 NEW WEST DISTRICT
PLAN 55
PID: 011-454-644

PARCEL 1 DISTRICT LOT 202 GROUP 1 NEW WESTMINSTER DISTRICT
REFERENCE PLAN 78562
PID: 011-707-224

The approximate centre of the site using the NAD (North American Datum) 1983 convention is:

Latitude: 49° 16' 40.9"
Longitude: 122° 51' 35.5"

2017-12-20
Date Issued

Alan W. McCammon
For Director, *Environmental Management Act*

Site Plan, Port Moody, BC

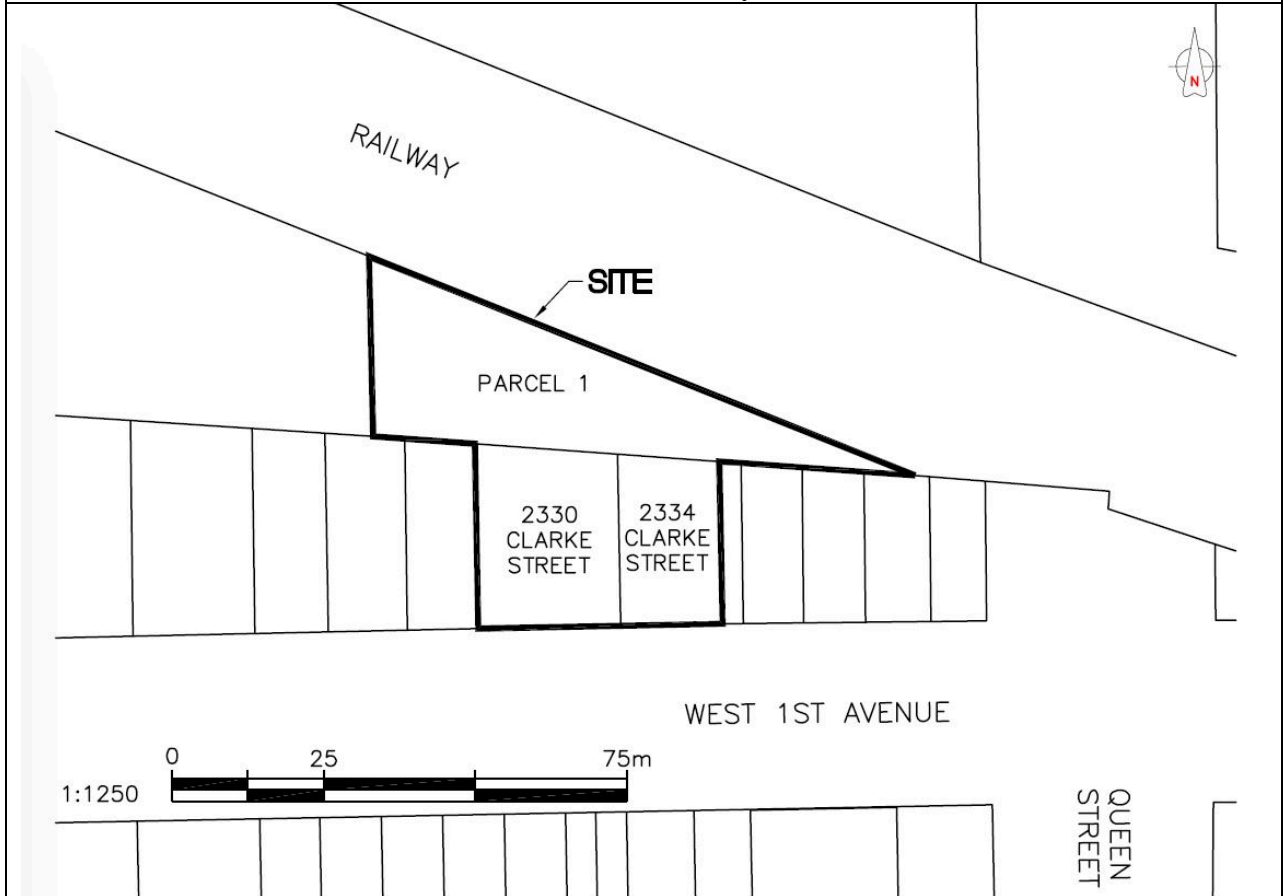

Location Map, Port Moody, BC



2017-12-20
Date Issued

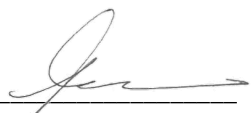

Alan W. McCammon
For Director, Environmental Management Act

Schedule B

Requirements and Conditions

1. Any changes in land use must be promptly identified by the responsible person in a written submission to the Director. An application for an amendment or new Certificate of Compliance may be necessary. The use to which this condition applies is described in Schedule C and in the site investigation documents listed in Schedule D.

2017-12-20
Date Issued

Alan W. McCammon
For Director, *Environmental Management Act*

Schedule C

Substances and Uses

Substances remediated in soil for residential land soil use:

To meet numerical remediation standards:

- Arsenic, barium, cadmium, copper, lead, selenium, tin, and zinc.

2017-12-20
Date Issued

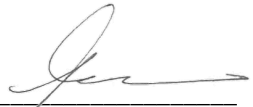

Alan W. McCammon
For Director, *Environmental Management Act*

Schedule D

Documents

- *Confirmation of Remediation - 2330, 2334 Clarke Street & Parcel 1 Port Moody, BC*, prepared by Active Earth Engineering Ltd., dated October 2017;
- *Summary of Site Condition*, prepared by Jeff Taylor / Active Earth Engineering Ltd., dated October 2017;
- *Detailed Site Investigation - 2330, 2334 Clarke Street & Parcel 1 Port Moody, BC*, prepared by Active Earth Engineering Ltd., dated July 2017;
- *Stage 2 Preliminary Site Investigation - 2330, 2334 Clarke Street & Parcel 1 Port Moody, BC*, prepared by Active Earth Engineering Ltd., dated March 2017; and
- *Stage 1 Preliminary Site Investigation - 2330, 2334 Clarke Street & Parcel 1 Port Moody, BC*, prepared by Active Earth Engineering Ltd., dated November 2015.

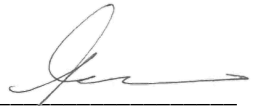
2017-12-20
Date Issued

Alan W. McCammon
For Director, *Environmental Management Act*
