

CSAP PROFESSIONAL DEVELOPMENT WEBINAR: CSAP Submissions

2018 SEPT 19



CSAP

Society of Contaminated
Sites Approved Professionals
of British Columbia

WEBINAR INFORMATION

- The Webinar consists of a Adobe Connect website portal which was supplied to you as a link and where the presentations can be viewed.
- Should you wish, your computer speakers can be used to hear the presentation.
- Should you not be able to hear the presentation please also dial in to the conference call line supplied to you (please note your line will be muted) Phone Number **1-855-747-8824 - PASSWORD 728369.**
- Questions should be typed in in the chatbox and will be answered by the presenters.

WEBINAR PRESENTERS

Bob Symington, P .Geo.	Gandalf Consulting Ltd.	Moderator/Speaker
Lori Larsen, P.Ag.	TRI Environmental Consulting Inc.	Speaker
Paul Webb, P.Geo	Hemmera Envirochem Inc.	Speaker
James Smith, R.P. Bio	City of Vancouver	Speaker

OVERVIEW

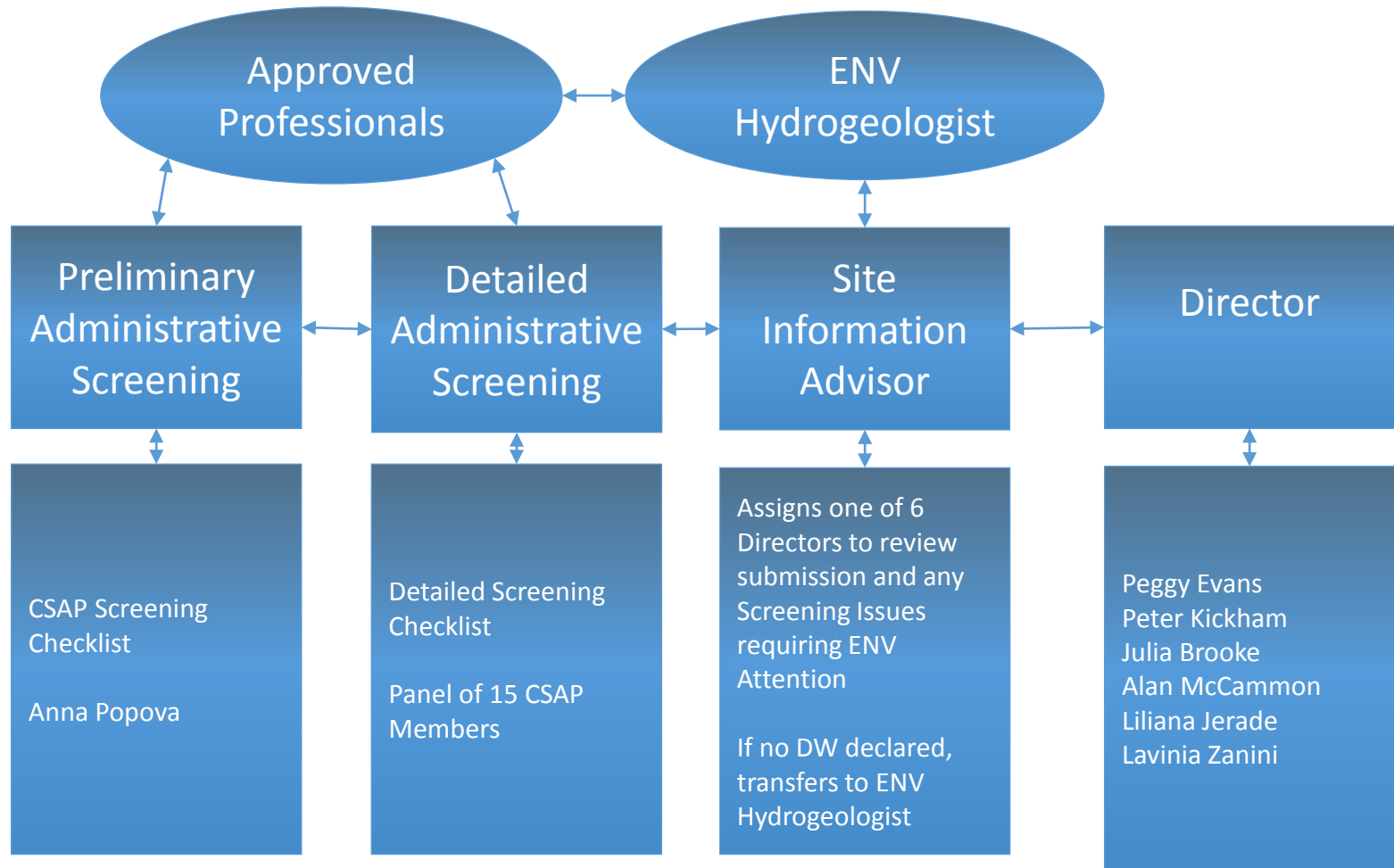

CSAP TOOLS FOR SUBMITTING APs

~ Bob Symington

CSAP TOOLS FOR SUBMITTING APs

CSAP Members – Make a Submission

<https://csapsociety.bc.ca/members/make-a-submission/>

- Mandatory Transmittal Letter Template
- AG11 Communications Template
- AP Arms Length Review Template

CSAP TOOLS FOR SUBMITTING APs

CSAP Screening List – PAS and DAS Checklist

<https://csapsociety.bc.ca/members/guidelines/submission-screening/>

- Annotated SoSC and Word Copy of SoSC
- ENV Borehole Form
- CSAP Webinars (SLRA, Omnibus Standards Review, Lessons Learned)

CSAP SUBMISSION MANAGER TOOLS FOR SUBMITTING APs

- Instruments Released from ENV
- ENV Templates in effect Nov 1st, 2018
- Submission Manager

ENV TOOLS FOR SUBMITTING APs

- Admin Guidance 3 - Applying for Contaminated Sites Services
- Admin Guidance 5 - Approved Professional Recommendations for Non-High Risk Sites
- Procedure 3: Ministry Procedures for the Roster of Approved Professionals

ENV TOOLS FOR SUBMITTING APs

- Procedure 6: Establishing the Boundaries of a Site (PDF)
- Procedure 12: Procedures for preparing and issuing contaminated sites legal instruments
- Protocol 6: Eligibility of Applications for Review by Approved Professionals (PDF)

TRANSMITTAL LETTER

~ James Smith

TRANSMITTAL LETTER (part 1)

Re: Approved Professional Submission Package for a Recommendation under Protocol 6 for a (Instrument)

Site Owner: XXXXXXXXXXXXXXXXXXXX

Responsible Person: XXXXXXXXXXXXXXXXXXXX

Civic Address of Site: XXXXXXXXXXXXXXXXXXXX,
British Columbia

BC ENV File No: 26250-20/XXXXX

SITE No.: XXXXX

TRANSMITTAL LETTER (part 2)

(AP Name) of (Company name) has reviewed the reports submitted in support of this application as per the attached Summary of Site Condition for a: (Instrument)

Please accept the attached materials in support of the attached recommendation by (AP Name) under BC Ministry of Environment (ENV) document *Protocol 6 For Contaminated Sites, Eligibility of Applications for Review by Approved Professionals* for issuance of a (Instrument) for (Site Civic Address), British Columbia.

If you have questions or require additional information, please contact the undersigned.

Yours truly,
(Company name)

(AP Name)

TRANSMITTAL LETTER

Templates:

Page 1



613 - 744 West Hastings
Vancouver, BC
Canada V6C 1A5
T: 604.451.4555
F: 604.451.4558
CSAPSociety.bc.ca

CSAP Submission Transmittal Letter

Submitting Company Name	<input type="text"/>
Risk AP Name	<input type="text"/>
STD AP Name	<input type="text"/>
Is there anything CSAP and ENV need to know about this application? (e.g. change of address, owner, parcel subdivision, previous communication with ENV, etc.)	<input type="text"/>
To avoid potential conflicts of interest during CSAP Detailed Administrative Screening and/or Performance Assessments, check this box if the site (and/or associated sites) is involved in or pending litigation.	<input type="checkbox"/>

Instrument 1	<input type="text"/>		
Site ID	<input type="text"/>		
Address	<input type="text"/>		
PID	<input type="text"/>		
Owner	<input type="text"/>		
Applicant	<input type="text"/>		
Latitude	<input type="text"/>	<input type="text"/>	<input type="text"/>
Longitude	<input type="text"/>	<input type="text"/>	<input type="text"/>
Comment (source, off-site, future dedication, etc.)	<input type="text"/>		

Page 2

CSAP Submission Transmittal Letter

	Document Title	Author/Company	Report Date (dd/mm/yyyy)	Report Location (included or appended)
1	<input type="text"/>	<input type="text"/>	<input type="text"/>	<input type="text"/>
2	<input type="text"/>	<input type="text"/>	<input type="text"/>	<input type="text"/>
3	<input type="text"/>	<input type="text"/>	<input type="text"/>	<input type="text"/>
4	<input type="text"/>	<input type="text"/>	<input type="text"/>	<input type="text"/>
5	<input type="text"/>	<input type="text"/>	<input type="text"/>	<input type="text"/>
6	<input type="text"/>	<input type="text"/>	<input type="text"/>	<input type="text"/>
7	<input type="text"/>	<input type="text"/>	<input type="text"/>	<input type="text"/>
8	<input type="text"/>	<input type="text"/>	<input type="text"/>	<input type="text"/>
9	<input type="text"/>	<input type="text"/>	<input type="text"/>	<input type="text"/>
10	<input type="text"/>	<input type="text"/>	<input type="text"/>	<input type="text"/>
11	<input type="text"/>	<input type="text"/>	<input type="text"/>	<input type="text"/>
12	<input type="text"/>	<input type="text"/>	<input type="text"/>	<input type="text"/>
13	<input type="text"/>	<input type="text"/>	<input type="text"/>	<input type="text"/>
14	<input type="text"/>	<input type="text"/>	<input type="text"/>	<input type="text"/>
15	<input type="text"/>	<input type="text"/>	<input type="text"/>	<input type="text"/>
16	<input type="text"/>	<input type="text"/>	<input type="text"/>	<input type="text"/>
17	<input type="text"/>	<input type="text"/>	<input type="text"/>	<input type="text"/>
18	<input type="text"/>	<input type="text"/>	<input type="text"/>	<input type="text"/>
19	<input type="text"/>	<input type="text"/>	<input type="text"/>	<input type="text"/>
20	<input type="text"/>	<input type="text"/>	<input type="text"/>	<input type="text"/>

TRANSMITTAL LETTER

Templates:





Page 3

Additional documentation is attached to this letter as noted below.

REQUIRED







	Cheque made payable to the CSAP Society for applicable CSAP fees and a separate cheque made payable to the Minister of Finance for applicable MoE fees
---	--

STANDALONE DOCUMENTATION (electronic [pdf or word as specified] file) on a CD or memory stick:

	Completed Contaminated Site Service Application Form
	Draft Instrument Cover Letter – word version
	Draft Instrument – word version
	Completed Summary of Site Condition (CSAP annotated version used)

Page 4 of 6

CSAP Submission Transmittal Letter

	Completed Site Risk Classification Form (not required for negative Determinations)
	Completed Technical Guidance 10 (PSI checklist)
	Completed Technical Guidance 11 (DSI Checklist)
	Copy of applicable Land Title Office legal plan(s) or other land survey results (current title within last 6 months)
	Area Based Site Registry Search, 0.5 km radius (current search within the last 6 months)
	Detailed Site Registry Search (current report within the last 6 months)

Page 4

ADDITIONAL STANDALONE DOCUMENTS (included as appropriate in electronic (pdf) format):

	INCLUDED	NOTES
PERFORMANCE VERIFICATION PLAN	<input type="radio"/> Included <input checked="" type="radio"/> NA	Enter notes here
NOTICE OF INDEPENDENT REMEDIATION (INITIATION AND COMPLETION)	<input type="radio"/> Included <input type="radio"/> NA	Enter notes here
Notice of Off-Site Migration	<input type="radio"/> Included <input type="radio"/> NA	Enter notes here
Consent of both owners to join sites	<input type="radio"/> Included <input type="radio"/> NA	Enter notes here
Administrative Guidance 11 communication records	<input type="radio"/> Included <input type="radio"/> NA	Enter notes here
Typical Borehole Log (PDF with disclaimer and MoE excel form) for MOE mapping	<input type="radio"/> Included <input type="radio"/> NA	Enter notes here
Preapproval and Approvals required under protocols (2,3,4,6,7 and 9)	<input type="radio"/> Included <input type="radio"/> NA	Enter notes here
Supporting Documents for use of PAAD Attenuation TG4	<input type="radio"/> Included <input type="radio"/> NA	Enter notes here
Other as Applicable:	<input type="radio"/> Included <input type="radio"/> NA	Enter notes here

Please include an alternative company contact that can be contacted in your absence regarding the submission.

Enter name here	Enter Phone here	Enter Email here
Name	Phone	Email

CONTAMINATED SITES SERVICES APPLICATION FORM

~ Lori Larsen

CONTAMINATED SITES SERVICES APPLICATION FORM (CSSAF)

Mandatory for ANY submission to BC ENV

Form Availability – Home > Environmental Protection & Sustainability > Air, Land & Water > Site Remediation > Guidance & Resources > Site Remediation Forms

<https://www2.gov.bc.ca/gov/content/environment/air-land-water/site-remediation/guidance-resources/forms>

Relevant ENV Documents:

- AG3 – Applying for Contaminated Site Services
- Procedure 12 – Section 7.2.2

CONTAMINATED SITES SERVICES APPLICATION FORM (CSSAF)

Who is the Applicant?

Should be the same as on SoSc Part 1: Cover Sheet

Procedure 12 Sec 7.2.2

- Determinations:
Not specified
- AiPs: Only a responsible person
- CoCs: Anyone
- CSRAs: The person relocating the soil

Who is the Billing Contact ? Whoever issues the cheques

Part A - Applicant Information	
First name	Last name
Organization (if applicable)	
Address	
City	Province/State Postal code
Telephone	Fax E-mail

Part B - Billing Contact		<input type="checkbox"/> Same as applicant	HST exempt?	<input type="checkbox"/> Yes	<input type="checkbox"/> No
First name	Last name				
Organization (if applicable)					
Address					
City	Province/State	Postal code			
Telephone	Fax	E-mail			

CSSAF – MOST COMMON MISTAKES & OMISSIONS

Most Common Mistakes Noted by CSAP Screener

- Part C: In addition to checking off the legal instrument you are applying for you must also check off SoSC in “Other Services”

Telephone		Fax		E-mail	
Part C - Application Information				Select one or more of the listed services	
Services Requested as listed in Contaminated Sites Regulation Schedule 3 Table 2 and Table 3					
Report Reviews		Other services			
<input type="checkbox"/> Preliminary site investigation		<input checked="" type="checkbox"/> Summary of Site Condition	<input type="checkbox"/> Monitoring report		
<input type="checkbox"/> Detailed site investigation		<input type="checkbox"/> Determination of Contaminated Site	<input type="checkbox"/> Transfer agreement		
<input type="checkbox"/> Remediation plan without risk assessment		<input type="checkbox"/> Approval in Principle	<input type="checkbox"/> Covenant		
<input type="checkbox"/> Remediation plan with risk assessment		<input type="checkbox"/> Certificate of Compliance	<input type="checkbox"/> Additional services / functions		
<input type="checkbox"/> Risk assessment not in remediation plan		<input type="checkbox"/> Voluntary Remediation Agreement	<input type="checkbox"/> Allocation panel		
<input type="checkbox"/> Confirmation of remediation		<input type="checkbox"/> Wide area site designation			
<input type="checkbox"/> Background substance concentrations		<input type="checkbox"/> Minor contributor determination			
<input checked="" type="checkbox"/> Site-specific numerical standards		<input type="checkbox"/> Contaminated Soil Relocation Agreement			
Process	<input type="checkbox"/> Ministry review	<input type="checkbox"/> External review	<input checked="" type="checkbox"/> Roster submission	Resubmission?	<input type="checkbox"/> Yes <input checked="" type="checkbox"/> No
Part D - Site Information				Please attach additional pages, if necessary	
Site ID (if applicable)					

CSSAF – MOST COMMON MISTAKES & OMISSIONS continued

- Part D: Mistakes and typos are found in the Site Information Section.
 - The text should match the draft instrument Schedule A. Use a separate page if necessary.
 - Add proper property owner. Should match SoSC Part 1: Cover Page

Part D - Site Information		Please attach additional pages, if necessary
Site ID (if applicable)		
Civic Address		
Legal Address		
Parcel Identifier (PID/PIN)		
Latitude		Longitude
Is applicant the property owner?	<input type="checkbox"/> Yes <input type="checkbox"/> No	If no, provide owner name
Site Risk Classification	<input type="checkbox"/> High Risk <input type="checkbox"/> Non-high Risk <input type="checkbox"/> Risk Managed High Risk	

All contaminated sites reports submitted after April 1, 1997 are considered routinely releasable under the *Freedom of Information and Protection of Privacy Act*.
For additional information please contact the Client Information Officer at msp_cio@victoria1.gov.bc.ca

CSSAF – How to Avoid Mistakes

- Using the Submission Manager will automatically fill out your CSSAF up to Part D.
- You NEED to fill out Part E – Key Information Requirements.

CSSAF – MOST COMMON MISTAKES & OMISSIONS continued

- Part E: Not filling Part E – Key Information

- Sigh, yes you must....

Part E - Key Information Requirements				
A satisfactorily completed Summary of Site Condition (SoSC) must be submitted to the ministry with each service application. Such applications must also be accompanied with site investigation reports, remediation plans and confirmation of remediation and risk assessment reports as applicable to the application. The checklist below must be completed for submissions for detailed review by ministry staff.				
Type of Report	Ministry References*	Key Report Deliverables	Included in Report(s)	Report References**
All types	CSR 63	Clear report conclusions. Assessment of the adequacy of previous investigation and remediation documentation and the extent to which it was, or was not, relied upon. Detailed descriptions of field and laboratory methods (including QA/QC). Fully supported explanations shall be provided for any deviations from ministry guidance, other documentation etc. Professional statements. Report authors must ensure that report waiver or liability clauses do not preclude ministry reliance on the information presented.	<input type="checkbox"/>	<input type="checkbox"/>
Preliminary Site Investigation		Copy of up to date land title record and legal sketch plan or engineering drawing. Evidence of area-based Site Registry search.	<input type="checkbox"/>	<input type="checkbox"/>
Stage 1	CSR 58 and 12; Technical Guidance 10	Figure showing onsite and offsite areas of potential environmental concern (APEC) and contaminants of potential concern associated with each APEC. Clearly supported specification of land and water uses, and site-specific factors applicable to the site.	<input type="checkbox"/>	<input type="checkbox"/>
Stage 2	CSR 58 and 12; Technical Guidance 1, 3, 6, 10	Figure(s) showing the general areas of environmental concern (AECs) and contaminants of concern (COCs) associated with each AEC in onsite and offsite soil and water. Sample locations and corresponding analytical results shall be shown on each figure and in tabular form with reference to applicable standards.	<input type="checkbox"/>	<input type="checkbox"/>
Detailed Site Investigation	CSR 59 and 1 (definition of remediation plan, item (a)); Technical Guidance 1, 2, 3, 6, 11, 12	Figures (plan and section), with contours, showing the specific lateral and vertical distribution of each COC in onsite and offsite soil and water. Sections must be longitudinal and transverse with respect to groundwater flow and include physical conditions (e.g. stratigraphy, water table etc.). Sample locations with corresponding analytical results used to develop each figure must be shown on the figure and in tabular form with reference to applicable standards.	<input type="checkbox"/>	<input type="checkbox"/>
Remediation Plan	CSR 1 (definition of remediation plan); Technical Guidance 1, 2, 3, 6, 12	Plan shall address each applicable item in CSR 1 definition of remediation plan i.e. (a) through (j). Signed/sealed plans and statement of assurance for any remediation system design included in the remediation plan. Legal sketch plan or engineering drawing showing boundaries of any offsite contamination.	<input type="checkbox"/>	<input type="checkbox"/>
Remediation confirmation	CSR 49(2); Technical Guidance 1, 2, 3, 6, 12	Figure(s) showing the lateral and vertical extent of any treated or removed contamination. Confirmatory sample locations and corresponding analytical results must be shown on each figure and in tabular form with reference to applicable standards. Conclusion stating to what standards the contaminated site has been remediated and how any requirements imposed (e.g. conditions in an Approval in Principle, order requirements etc.) have been met. Legal sketch plan or engineering drawing showing boundaries of any offsite remediation.	<input type="checkbox"/>	<input type="checkbox"/>
Site Risk Classification	EMA 64(2)(i); Protocol 11, 12, 16	Site Risk Classification Report Form Exposure Pathway Questionnaire	<input type="checkbox"/>	<input type="checkbox"/>

CSSAF – PART E – Handy Tip

✓ Handy Tip

Use your report table from your SoSC as a Legend to the Reports for Part E.

Then you only need to list the reports as #1, #2, #3, #4, etc. with the actual Sections, pp. or Figure #s.

PART 3: DOCUMENT SUMMARY

(List of all known site investigation, risk assessment (including screening level risk assessment), remediation plan and confirmation of remediation reports completed and directly supporting correspondence submitted (subject site and offsite impacted sites).

#	Document Title	Author/Company	Document Date (MMM/DD/YY)	Add	Delete
1	Stage 1 Preliminary Site Investigation - 1234 Colour Street, Rainbow City, BC	Qualified Professional, P.Eng/We do Everything Inc.	Jan/02/18	+	-
2	Stage 2 Preliminary Site Investigation - 1234 Colour Street, Rainbow City, BC	Qualified Professional, P.Eng/We do Everything Inc.	Feb/04/18	+	-
3	Detailed Site Assessment - 4321 Lego Place, Rainbow City, BC (formerly 1234 Colour Street)	Qualified Professional, P.Eng/We do Everything Inc.	May/05/18	+	-
4	Confirmation of Remediation - 4321 Lego Place, Rainbow City	Qualified Professional, P.Eng/We do Everything Inc.	Aug/15/18	+	-

CSSAF – PART E – Example 1

Edit PDF

Edit Add Text Add Image Link Crop Pages Header & Footer Watermark More

Part E - Key Information Requirements

A satisfactorily completed Summary of Site Condition (SoSC) must be submitted with all applications must also be accompanied with site investigation reports, remediation reports as applicable to the application. The checklist below staff.

PART 3: DOCUMENT SUMMARY

(List of all known site investigation, risk assessment (including screening level risk assessment), remediation plan and confirmation of remediation reports completed and directly supporting correspondence submitted (subject site and offsite impacted sites).

#	Document Title	Author/Company	Document Date (MMM/DD/YY)	Add	Delete
1	Stage 1 Preliminary Site Investigation - 1234 Colour Street, Rainbow City, BC	Qualified Professional, P.Eng/We do Everything Inc.	Jan/02/18	+	-
2	Stage 2 Preliminary Site Investigation - 1234 Colour Street, Rainbow City, BC	Qualified Professional, P.Eng/We do Everything Inc.	Feb/04/18	+	-
3	Detailed Site Assessment - 4321 Lego Place, Rainbow City, BC (formerly 1234 Colour Street)	Qualified Professional, P.Eng/We do Everything Inc.	May/05/18	+	-
4	Confirmation of Remediation - 4321 Lego Place, Rainbow City	Qualified Professional, P.Eng/We do Everything Inc.	Aug/15/18	+	-

Type of Report	Ministry References*	Key Report Deliverables	Included in Report(s)	Report References**
All types	CSR 63	<p><u>Clear report conclusions.</u> Assessment of the adequacy of previous investigation and remediation documentation and the extent to which it was, or was not, relied upon.</p> <p>Detailed descriptions of field and laboratory methods (including QA/QC). Fully supported explanations shall be provided for any deviations from ministry guidance, other documentation etc.</p> <p>Professional statements. Report authors must ensure that report waiver or liability clauses do not preclude ministry reliance on the information presented.</p>	<input checked="" type="checkbox"/> #1, #2, #3, #4 - Executive Summary #2, #3, #4 - Section 6 <input checked="" type="checkbox"/> #1, #2: Section 3 #3, #4: Section 4 <input checked="" type="checkbox"/> #1, #2, #3, #4: Section 2	
Preliminary Site Investigation		Copy of up to date land title record and legal sketch plan or engineering drawing. Evidence of area-based Site Registry search.	<input checked="" type="checkbox"/>	#1 - Appendix B
Stage 1	CSR 58 and 12; Technical Guidance 10	<p>Figure showing onsite and offsite areas of potential environmental concern (APEC) and contaminants of potential concern associated with each APEC.</p> <p>Clearly supported specification of land and water uses, and site-specific factors applicable to the site.</p>	<input checked="" type="checkbox"/> <input checked="" type="checkbox"/>	#1 - Figure 4 #1 - Section 5
Stage 2	CSR 58 and 12	Figure(s) showing the <u>general</u> areas of environmental concern (AECs)	<input checked="" type="checkbox"/>	#2: Figures 4, 5, 6 and 7

CSSAF – PART E – Example 2

Part E - Key Information Requirements				
<p>A satisfactorily completed Summary of Site Condition (SoSC) must be submitted to the ministry with each service application. Such applications must also be accompanied with site investigation reports, remediation plans and confirmation of remediation and risk assessment reports as applicable to the application. The checklist below must be completed for submissions for detailed review by ministry staff.</p>				
Type of Report	Ministry References*	Key Report Deliverables.	Included in Report(s)	Report References**
All types	CSR 63	<p>Clear report conclusions. Assessment of the adequacy of previous investigation and remediation documentation and the extent to which it was, or was not, relied upon.</p> <p>Detailed descriptions of field and laboratory methods (including QA/QC). Fully supported explanations shall be provided for any deviations from ministry guidance, other documentation etc.</p> <p>Professional statements. Report authors must ensure that report waiver or liability clauses do not preclude ministry reliance on the information presented.</p>	<input checked="" type="checkbox"/> a <input checked="" type="checkbox"/> b <input checked="" type="checkbox"/> c	
Preliminary Site Investigation			<input checked="" type="checkbox"/> Attached to submission	
Stage 1	CSR 58 and 12; Technical Guidance 10	<p>Copy of up to date land title record and legal sketch plan or engineering drawing. Evidence of area-based Site Registry search.</p> <p>Figure showing onsite and offsite areas of potential environmental concern (APEC) and contaminants of potential concern associated with each APEC.</p> <p>Clearly supported specification of land and water uses, and site-specific factors applicable to the site.</p>	<input checked="" type="checkbox"/> d <input checked="" type="checkbox"/> e	
Stage 2	CSR 58 and 12; Technical Guidance 1, 3, 6, 10	Figure(s) showing the general areas of environmental concern (AECs) and contaminants of concern (COCs) associated with each AEC in onsite and offsite soil and water. Sample locations and corresponding analytical results shall be shown on each figure and in tabular form with reference to applicable standards.	<input checked="" type="checkbox"/> f	
Detailed Site Investigation	CSR 59 and 1 (definition of remediation plan, item (a)); Technical Guidance 1, 2, 3, 6, 11, 12	Figures (plan and section), with contours, showing the specific lateral and vertical distribution of each COC in onsite and offsite soil and water. Sections must be longitudinal and transverse with respect to groundwater flow and include physical conditions (e.g. stratigraphy, water table etc.). Sample locations with corresponding analytical results used to develop each figure must be shown on the figure and in tabular form with reference to applicable standards.	<input checked="" type="checkbox"/> g	
Remediation Plan	CSR 1 (definition of remediation plan); Technical Guidance 1, 2, 3, 6, 12	<p>Plan shall address each applicable item in CSR 1 definition of remediation plan i.e. (a) through (j).</p> <p>Signed/sealed plans and statement of assurance for any remediation system design included in the remediation plan.</p> <p>Legal sketch plan or engineering drawing showing boundaries of any offsite contamination.</p>	<input type="checkbox"/> <input type="checkbox"/> <input type="checkbox"/>	
Remediation confirmation	CSR 49(2); Technical Guidance 1, 2, 3, 6, 12	<p>Figure(s) showing the lateral and vertical extent of any treated or removed contamination. Confirmatory sample locations and corresponding analytical results must be shown on each figure and in tabular form with reference to applicable standards.</p> <p>Conclusion stating to what standards the contaminated site has been remediated and how any requirements imposed (e.g. conditions in an Approval in Principle, order requirements etc.) have been met.</p> <p>Legal sketch plan or engineering drawing showing boundaries of any offsite remediation.</p>	<input checked="" type="checkbox"/> h <input checked="" type="checkbox"/> i <input checked="" type="checkbox"/> Attached to submission	
Site Risk Classification	EMA 64(2)(i); Protocol 11, 12, 16	<p>Site Risk Classification Report Form</p> <p>Exposure Pathway Questionnaire</p>	<input checked="" type="checkbox"/> Attached to submission <input type="checkbox"/>	

Part F - Signature	
Signed : Duncan Macdonald	Dated : Sep 16, 2014
Print Name	Signature
I am acting as agent for the applicant <input type="checkbox"/> Yes <input checked="" type="checkbox"/> No Telephone 604 682 3707 Fax 604 682 3497	

* CSR stands for the Contaminated Sites Regulation; EMA stands for the Environmental Management Act.
 ** Note the section(s), page(s) and/or figure number(s). Use a separate sheet if necessary.

Appendix A – Additional PIDs and Legal Descriptions

Legal Description	Civic Address	PID
Lot 4 through Lot 9, Block 1, District Lot 318, Plan 2067, New Westminster Land District.	1314-1348 Southwest Marine Drive, Vancouver, BC	014-052-113 (Lot 4) 014-052-121 (Lot 5) 014-052-130 (Lot 6) 014-052-148 (Lot 7) 014-052-156 (Lot 8) 014-052-164 (Lot 9)

Report References

- SoSC Report #17 (Stage 1), Section 6.1 and Report #18, Section 3.0
- SoSC Report #18 (Stage 2 PSI, DSI, COR) Section 6.1.4 and Appendix 9
- SoSC Report #18 (Stage 2 PSI, DSI, COR) Section 11
- SoSC Report #17 (Stage 1) Figure 5
- SoSC Report #17 (Stage 1) Section 5
- SoSC Report #18 (Stage 2 PSI, DSI, COR) Figure 4 through Figure 17
- SoSC Report #18 (Stage 2 PSI, DSI, COR) Figure 18 through Figure 28c
- SoSC Report #18 (Stage 2 PSI, DSI, COR) Figure 19
- SoSC Report #18 (Stage 2 PSI, DSI, COR) Section 8 and Section 10

SUMMARY OF SITE CONDITIONS

~ Paul Webb

SUMMARY OF SITE CONDITIONS

Provides the ENV with:

summary of key site information regarding status of investigations
the nature and extent of remediation proposed or undertaken
further work that will be required part of legislated and regulated
closure documentation.

The Summary of Site Condition can also provide information to
persons managing contaminants on adjacent property.

SUMMARY OF SITE CONDITIONS

Where to find:

Click: Members Area

then

Make a Submission

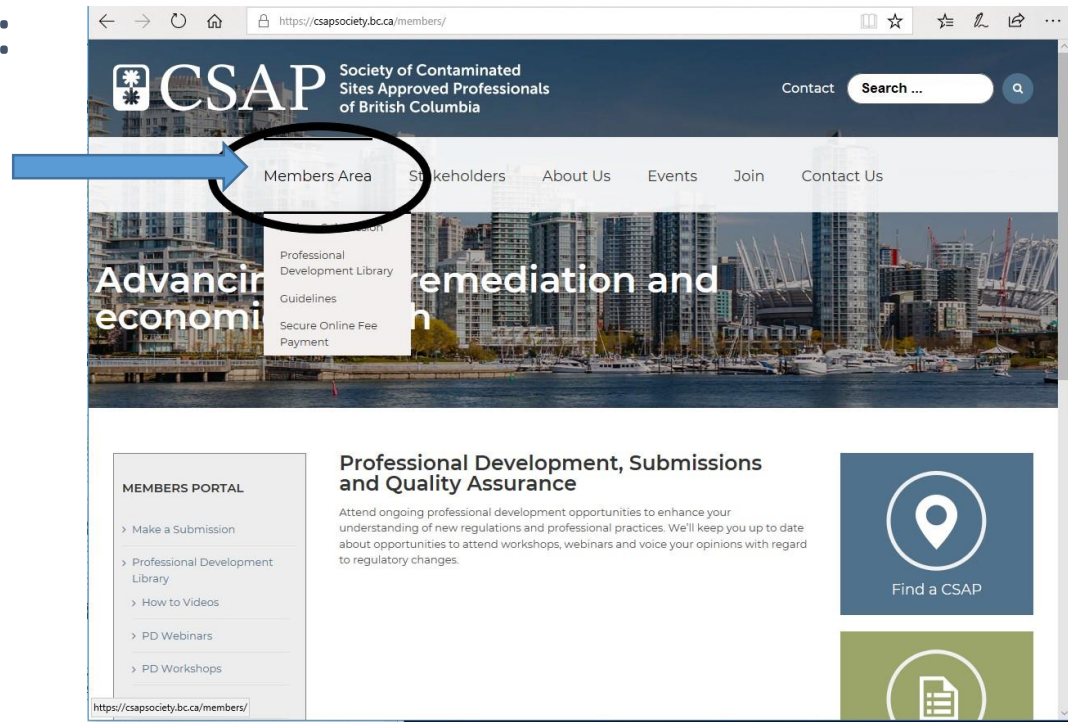

SUMMARY OF SITE CONDITIONS

Where to find:

Members Area:

Fillable SoSC and
Annotated SoSC

The screenshot displays the CSAP Members Area interface. On the left is a 'MEMBERS PORTAL' sidebar with a list of links: 'Make a Submission', 'Professional Development Library', 'How to Videos', 'PD Webinars', 'PD Workshops', 'Members Updates', 'Technical Studies', 'Links of Interest', 'Guidelines', 'Discipline', 'Membership', 'Performance Assessment', and 'Practice'. A blue arrow points from the 'Technical Studies' link to the 'ENV SoSC Form' and 'CSAP Annotated SoSC' links in the main content area. The main content area is titled 'CSAP Members Area' and includes a welcome message, a list of tasks (Make a CSS application, Track submission progress, Find instrument templates, Track professional development hours), 'Submission Guidelines' with links to screening deficiencies and transmittal letters, and a table of submission forms. The table has two columns: 'ENV SoSC Form' and 'CSAP Annotated SoSC'. Both links in the table are circled in black. Below the table are links for 'CSAP AG 11 Communications Template (doc)', 'Arms Length Review of Submission Template (doc 38kb)', 'ENV Borehole Form (excel spreadsheet)', and 'CSAP Screening List'. On the right side of the interface are three large buttons: 'Find a CSAP' (blue with a location pin icon), 'Make a Submission' (green with a document icon), and 'Pay Fees' (brown with a dollar sign and circular arrow icon).

MEMBERS PORTAL

- > Make a Submission
- > Professional Development Library
- > How to Videos
- > PD Webinars
- > PD Workshops
- > Members Updates
- > Technical Studies
- > Links of Interest
- > Guidelines
- > Discipline
- > Membership
- > Performance Assessment
- > Practice

CSAP Members Area

Welcome, members! You can complete the following tasks through the CSAP Submissions Manager:

- Make a CSS application
- Track submission progress
- Find instrument templates
- Track professional development hours

Submission Guidelines

CSAP Screening Deficiencies 2012 – 2013 [pdf 67kb]

CSAP Transmittal Letter (submit Word version)

ENV SoSC Form	CSAP Annotated SoSC
ENV SoSC Form	CSAP Annotated SoSC
** Please use this form when submitting.	** Please refer to this Annotated version as a guide when completing the ENV SoSC Form.

CSAP AG 11 Communications Template (doc)

Arms Length Review of Submission Template [doc 38kb]

ENV Borehole Form (excel spreadsheet)

CSAP Screening List

Find a CSAP

Make a Submission

Pay Fees

SUMMARY OF SITE CONDITIONS

Where to find:

Fillable SoSC

MS Word version
with legal text
secured - can be
filled in and
saved.

SoSC has been
updated to
reflect Stage 10
and 11
amendments

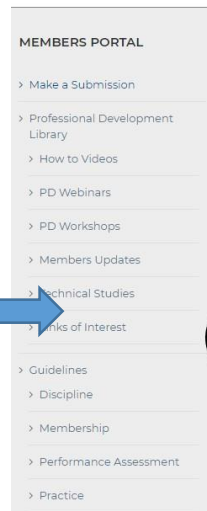

CSAP Members Area

Welcome, members! You can complete the following tasks through the CSAP Submissions Manager:

- Make a CSS application
- Track submission progress
- Find instrument templates
- Track professional development hours

Submission Guidelines

CSAP Screening Deficiencies 2012 - 2013 [pdf 67kb]

CSAP Transmittal Letter (submit Word version)

ENV SoSC Form	CSAP Annotated SoSC
ENV SoSC Form	CSAP Annotated SoSC
** Please use this form when submitting.	** Please refer to this Annotated version as a guide when completing the ENV SoSC Form.

CSAP AG 11 Communications Template (doc)

Arms Length Review of Submission Template [doc 38kb]

ENV Borehole Form (excel spreadsheet)

CSAP Screening List

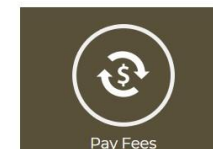
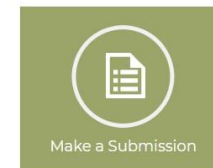
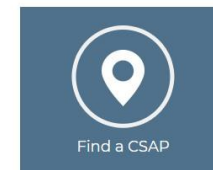

Fillable Summary of Site Conditions

Fillable form restricts data entry to the sections that we are legally allowed to modify.

Residential Land Uses updated

- Still need to select “Other” if Vapour Attenuation Factors applied
- Wildlands would also use “Other”

Soil (standards):

Property	CSR Land Use							
		AL	PL	RL _{LD}	RL _{HD}	CL	IL	Other
Subject site	Current	<input type="checkbox"/>	<input type="checkbox"/>	<input type="checkbox"/>	<input type="checkbox"/>	<input type="checkbox"/>	<input type="checkbox"/>	<input type="checkbox"/>
	Proposed	<input type="checkbox"/>	<input type="checkbox"/>	<input type="checkbox"/>	<input type="checkbox"/>	<input type="checkbox"/>	<input type="checkbox"/>	<input type="checkbox"/>
Receiving site <i>(if completed in support of a Contaminated Soil Relocation Agreement)</i>		<input type="checkbox"/>	<input type="checkbox"/>	<input type="checkbox"/>	<input type="checkbox"/>	<input type="checkbox"/>	<input type="checkbox"/>	<input type="checkbox"/>
Offsite impacted property / management area		<input type="checkbox"/>	<input type="checkbox"/>	<input type="checkbox"/>	<input type="checkbox"/>	<input type="checkbox"/>	<input type="checkbox"/>	<input type="checkbox"/>

If Other is specified above, please explain: *(applicable or excluded guidance, protocols or policies specific to the site)*

[]

Fillable Summary of Site Conditions

Part 3: Document Summary

(List of all known site investigation, risk assessment (including screening level risk assessment), remediation plan and confirmation of remediation reports completed and directly supporting correspondence submitted (subject site and offsite impacted sites).)

#	Document Title	Author / Company	Document Date

Should also be listed:

- performance verification plans;
- approvals and preapprovals under protocols (e.g., 2 – 4, 6, 7, and 9) to establish, for example, background levels of substances and site-specific standards;
- determinations of land, water, sediment or vapour use by a Director;
- discharge authorizations issued under Section 6 of the EMA;
- hazardous waste authorizations

Fillable Summary of Site Conditions

4.2. Site Conditions – Hydrogeology Current Use

Hydrogeology

Describe groundwater levels, confining / semi-confining layers, flow direction and velocity

For Current Use:

- state whether there are any drinking water, irrigation or livestock watering wells within 500m of the site.
- indicate if a background groundwater decision was obtained and for what COCs.
- at a site with bedrock aquifer, indicate whether groundwater contamination reaches the bedrock surface.

- state whether there are any drinking water, irrigation or livestock watering wells within 500m of the site.
- indicate if a background groundwater decision was obtained and for what COCs.
- at a site with bedrock aquifer, indicate whether groundwater contamination reaches the bedrock surface.

Fillable Summary of Site Conditions

Hydrogeology section contains P21 Water Use Evaluation flow chart information

Hydrogeology

Describe groundwater levels, confining / semi-confining layers, flow direction and velocity

[]

P21 Water Use Evaluation

AW use:

Q: Is the site located within 500 m of an aquatic receiving environment? ☐ Yes (go to 1) ☐ No (go to 2)

1 - Can it be demonstrated that site groundwater does not flow to that aquatic receiving environment? ☐ Yes (go to 2) ☐ No (AW applies) Rationale:

Don't forget to provide rationale to support your evaluation!

Fillable Summary of Site Conditions

Section 5.6. Remediation Issues

For type 1B, 2 and 3 sites, list the principal risk control clauses.

5.6 Remediation Issues

Identify remaining issues if the remediation plan, confirmation of remediation report or risk assessment report does not include CSR specified information and current applicable ministry protocols, guidelines, checklists, etc. for these documents.

For type 1B, 2 and 3 sites, please list the principal risk control clauses in this section.

Fillable Summary of Site Conditions

Section 6.1 updated to reflect Stage 10 and 11 Amendments

6.1 Relocation with a Contaminated Soil Relocation Agreement

Source Site

(Soil to be relocated under the CSRA (from Table 4.6). Investigation information may be limited to the soil that is the subject of the relocation agreement)

APEC # (Use same #s as for APECS in Table above)	Contaminant of Concern (List separately)	Classification of the soil to be Relocated (\neq WL_N , WL_R , AL, PL, RL_{LD} , RL_{HD} , CL, IL; Columns 2 through 9) Schedule 3.1	Volume m ³

Receiving Site

Soil to be relocated has been adequately characterized?					<input type="checkbox"/> Yes	<input type="checkbox"/> No
Total Volume of soil to be relocated?					<input type="text"/>	m ³
Applicable CSR Land Use at receiving site	AL <input type="checkbox"/>	PL <input type="checkbox"/>	RL_{LD} <input type="checkbox"/>	RL_{HD} <input type="checkbox"/>	CL <input type="checkbox"/>	IL <input type="checkbox"/>

SUMMARY OF SITE CONDITIONS

Where to find:

Annotated SoSC

PDF version with
notes to facilitate
completing the
SoSC form

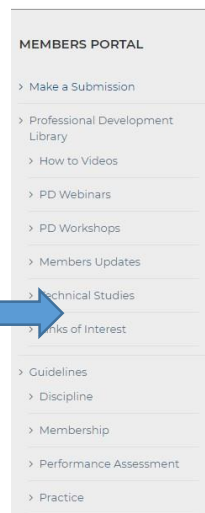

CSAP Members Area

Welcome, members! You can complete the following tasks through the CSAP Submissions Manager:

- Make a CSS application
- Track submission progress
- Find instrument templates
- Track professional development hours

Submission Guidelines

CSAP Screening Deficiencies 2012 – 2013 [pdf 67kb]

CSAP Transmittal Letter (submit Word version)

ENV SoSC Form	CSAP Annotated SoSC
ENV SoSC Form ** Please use this form when submitting.	CSAP Annotated SoSC ** Please refer to this Annotated version as a guide when completing the ENV SoSC Form.

CSAP AG 11 Communications Template [doc]
Arms Length Review of Submission Template [doc 38kb]
ENV Borehole Form (excel spreadsheet)
CSAP Screening List

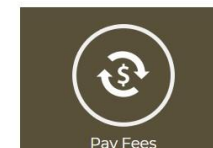
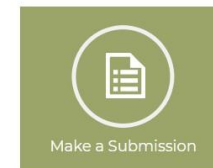

SUMMARY OF SITE CONDITIONS

Can also prepare through CSAP Submissions Manager:

MEMBERS PORTAL

- > Make a Submission
- > Professional Development Library
 - > How to Videos
 - > PD Webinars
 - > PD Workshops
- > Members Updates
- > Technical Studies
- > Links of Interest
- > Guidelines
 - > Discipline
 - > Membership
 - > Performance Assessment
 - > Practice

CSAP Members

Welcome, members! You can use the Submissions Manager:

- Make a CSS application
- Track submission progress
- Find instrument templates
- Track professional development

Submission Guideline:

CSAP Screening Deficiencies 2012 (word processing)

CSAP Transmittal Letter (submit Word version)

ENV SoSC Form	CSAP
ENV SoSC Form	CSAP Annotated SoSC
** Please use this form when submitting.	** Please refer to this Annotated version as a guide when completing the ENV SoSC Form.

CSAP AG 11 Communications Template (doc)

Arms Length Review of Submission Template [doc 38kb]

ENV Borehole Form (excel spreadsheet)

CSAP Screening List

Click here for Submissions Manager

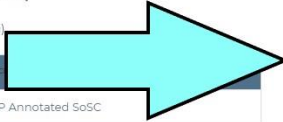

- Find a CSAP
- Make a Submission
- Pay Fees

CSAP Submission Manager

CSAP Submissions Manager improvements:

- Create your own Section 4.5 substance lists
- “Alias” for substance classes
- SoSC Table 4.5 shows Alias - lists parameters below table

CSAP Submission Manager

CSAP Submissions Manager

Custom Lists for adding Section 4.5 substances

Substances

Selected Substances

Add Substances to Submission

Cancel

These are the selected substances for the submission.

Remove Substance

Custom Substances

Add Substance Lists:

Add substances from a list (Substances will be added to the Selected Substances above).

BETX - Soil
PAHs - Soil
Metals
VOCs - Soil

Add All Substances From ListCreate / Edit Substance Lists

Add Individual Substances

Select single substances from the lists below (Substances will be added to the Selected Substances above).

Medium:

Soil

Search for names...

antimony
arsenic
barium
beryllium

Add Substance

Add Custom Substances:

Add custom substances (Substances will be added to the Selected Substances above):

Substance

Soil

Add Substance

CSAP Submission Manager

CSAP Submissions Manager

Section 4.5 substance lists

- Create custom lists of substances investigated for each media
- Manage your lists
- Add all list substances to submission

Substances

Selected Substances

Add Substances to Submission

Cancel

These are the selected substances for the submission.

Remove Substance

Custom Substances

VOCs - Soil

Remove

BETX - Soil

Remove

Add Substance Lists:

Add substances from a list (Substances will be added to the Selected Substances above).

BETX - Soil

PAHs - Soil

Metals

VOCs - Soil

Add All Substances From List

Create / Edit Substance Lists

Add Individual Substances

Select single substances from the lists below (Substances will be added to the Selected Substances above).

Medium:

Soil

Search for names..

CSAP Submission Manager

CSAP Submissions Manager

Section 4.5 substance lists

- You can create and manage your custom substance lists to suit your needs

Manage Substance Lists:

Substance Lists

BETX - Soil
PAHs - Soil
Metals
VOCs - Soil
Metals - Groundwater
3.1_PHCs
3.1_BETX

Edit List

Delete List

Create New List

Back

CSAP Submission Manager

CSAP Submissions Manager

Section 4.5 substance lists

- Create custom lists of substances investigated for each media
- Coming soon: create an alias for the list (eg. VOCs)

Add List

List name:

Add substances to your list.

Medium:

Class:

Substances

aniline
HEPHs
LEPHs
nonaqueous phase liquids
odorous substances
VPHs

Add >

< Rem

New List

Save List

Cancel

CSAP Submission Manager

CSAP Submissions Manager

Section 4.5 substance lists

- Your custom lists of substances can be edited at any time

Edit List

List name:

Add substances to your list.

Medium:

Class:

Substances

antimony
arsenic
barium
beryllium
boron (hot water soluble)
bromate
cadmium
chromium
cobalt
copper
fluoride
lead
lithium
manganese
mercury
molybdenum
nickel
selenium

Add >

< Rem

New List

antimony (Soil-Inorganic Substances)
beryllium (Soil-Inorganic Substances)
cobalt (Soil-Inorganic Substances)
fluoride (Soil-Inorganic Substances)
molybdenum (Soil-Inorganic Substances)
nickel (Soil-Inorganic Substances)
selenium (Soil-Inorganic Substances)
silver (Soil-Inorganic Substances)
thallium (Soil-Inorganic Substances)
tin (Soil-Inorganic Substances)
vanadium (Soil-Inorganic Substances)
barium (Soil-Inorganic Substances)
arsenic (Soil-Inorganic Substances)
cadmium (Soil-Inorganic Substances)
chloride Ion (Cl-) (Soil-Inorganic Substances)
chromium (Soil-Inorganic Substances)
copper (Soil-Inorganic Substances)
lead (Soil-Inorganic Substances)

Save List

Cancel

CSAP Submission Manager

CSAP Submissions Manager

Section 4.5 substance lists

- Your custom lists of substances are added to the Submissions Manager

Add Potential Contaminants of Concern

Potential Contaminant of Concern (PCOC) <i>(indicate products, chemicals, waste type, etc. and / or analytical parameter)</i>	Check where analyses completed						Delete
	Soil	Sediment	Ground Water	Surface Water	Vapour	Other (explain)	
1,2-dichloropropane	<input checked="" type="checkbox"/>	<input type="checkbox"/>	<input type="checkbox"/>	<input type="checkbox"/>	<input type="checkbox"/>	<input type="checkbox"/>	Delete
carbon tetrachloride	<input checked="" type="checkbox"/>	<input type="checkbox"/>	<input type="checkbox"/>	<input type="checkbox"/>	<input type="checkbox"/>	<input type="checkbox"/>	Delete
dichloroethane (1,1-, 1,2-)	<input checked="" type="checkbox"/>	<input type="checkbox"/>	<input type="checkbox"/>	<input type="checkbox"/>	<input type="checkbox"/>	<input type="checkbox"/>	Delete
dichloroethene (1,1-, 1,2-)	<input checked="" type="checkbox"/>	<input type="checkbox"/>	<input type="checkbox"/>	<input type="checkbox"/>	<input type="checkbox"/>	<input type="checkbox"/>	Delete
dichloromethane	<input checked="" type="checkbox"/>	<input type="checkbox"/>	<input type="checkbox"/>	<input type="checkbox"/>	<input type="checkbox"/>	<input type="checkbox"/>	Delete
trichloroethane (1,1,1-, 1,1,2-)	<input checked="" type="checkbox"/>	<input type="checkbox"/>	<input type="checkbox"/>	<input type="checkbox"/>	<input type="checkbox"/>	<input type="checkbox"/>	Delete
trichloroethylene (TCE)	<input checked="" type="checkbox"/>	<input type="checkbox"/>	<input type="checkbox"/>	<input type="checkbox"/>	<input type="checkbox"/>	<input type="checkbox"/>	Delete
1,3-dichloropropane	<input checked="" type="checkbox"/>	<input type="checkbox"/>	<input type="checkbox"/>	<input type="checkbox"/>	<input type="checkbox"/>	<input type="checkbox"/>	Delete
vinyl chloride (chloroethene)	<input checked="" type="checkbox"/>	<input type="checkbox"/>	<input type="checkbox"/>	<input type="checkbox"/>	<input type="checkbox"/>	<input type="checkbox"/>	Delete
styrene	<input checked="" type="checkbox"/>	<input type="checkbox"/>	<input type="checkbox"/>	<input type="checkbox"/>	<input type="checkbox"/>	<input type="checkbox"/>	Delete
benzene	<input checked="" type="checkbox"/>	<input type="checkbox"/>	<input type="checkbox"/>	<input type="checkbox"/>	<input type="checkbox"/>	<input type="checkbox"/>	Delete
ethylbenzene	<input checked="" type="checkbox"/>	<input type="checkbox"/>	<input type="checkbox"/>	<input type="checkbox"/>	<input type="checkbox"/>	<input type="checkbox"/>	Delete
toluene	<input checked="" type="checkbox"/>	<input type="checkbox"/>	<input type="checkbox"/>	<input type="checkbox"/>	<input type="checkbox"/>	<input type="checkbox"/>	Delete
xylene	<input checked="" type="checkbox"/>	<input type="checkbox"/>	<input type="checkbox"/>	<input type="checkbox"/>	<input type="checkbox"/>	<input type="checkbox"/>	Delete

[Remove APEC Description](#)

CSAP Submission Manager

Word Output of
Section 4.5
substance lists

- Your custom lists of substances are included in Table 4.5

- ..and the parameters listed below in a legend

Area of Potential Environmental Concern (APEC)		Potential Contaminant of Concern (PCOC) <i>(indicate products, chemicals, waste type, etc. and / or analytical parameter)</i>	Check where analyses completed					
#	Description <i>(describe location in relation to process source, waste, filling, land use or activity, etc. giving rise to APEC, and if APEC is primary due to soil or water contamination)</i>		Soil	Sediment	Ground water	Surface Water	Vapour	Other (explain)
1	Service Station	VOCs - Soil	<input type="checkbox"/>	<input type="checkbox"/>	<input type="checkbox"/>	<input type="checkbox"/>	<input type="checkbox"/>	<input type="checkbox"/>
		BETX - Soil	<input type="checkbox"/>	<input type="checkbox"/>	<input type="checkbox"/>	<input type="checkbox"/>	<input type="checkbox"/>	<input type="checkbox"/>

Other (please explain):

APEC #	

Substance Lists:

List Name	Substances
VOCs - Soil	1,2-dichloropropane, carbon tetrachloride, dichloroethane (1,1-, 1,2-), dichloroethene (1,1-, 1,2-), dichloromethane, trichloroethane (1,1,1-, 1,1,2-), trichloroethylene (TCE), 1,3-dichloropropane, vinyl chloride (chloroethene)
BETX - Soil	styrene, benzene, ethylbenzene, toluene, xylene

APPROVAL AND DIRECTORS DECISION:

Water Use Determination other than P21 and
Approval under P6

~ Lori Larsen

APPROVALS & DIRECTORS DECISIONS

Water Use Determination

Typical Approach Protocol 21

- Must be set out in detail in the SOSC and reports

Under P6 – Background Water Determination

- Using Protocol 9 and making a submission to the Director

Request that DW does not Apply to Site

- This an application that is sent to the Director. The application should:
 - give adequate evidence of hydrogeological investigation,
 - Submit reports of environmental investigation
 - Shows how it fails Protocol 21
 - Then give multiple lines of evidence to support the case that DW is not applicable

APPROVALS & DIRECTORS DECISIONS

Water Use Determination

- **Examples**
 - False Creek Flats (historical industrial use, historical contamination, unlikely gw use)
 - Fraser River in New Westminster (Westminster Pier Park)
 - Fractured Bedrock Sites beside Marine Waters
- **Must include the actual water use determination letter from BC ENV in your list of documents that support the application**

APPROVAL AND DIRECTORS DECISION: BACKGROUND DETERMINATION

~ James Smith

PRE-APPROVAL & DIRECTORS DECISION

Relevant ENV Document – Protocol 6 (Eligibility of Applications for Review by Approved Professionals)

Relevant Section: Section 4.9 (Page 4):

Pre-approval is needed for the Ministry for the types of applications detailed in Table 2 of Protocol 6 (Page 5)

Useful Reference: Protocol 6 pre-approvals issued by ENV: https://www2.gov.bc.ca/assets/gov/environment/air-land-water/site-remediation/docs/protocols/protocol_6.pdf

PRE-APPROVAL & DIRECTORS DECISION

Pre-approval Situations:

1. Delineation – Full extent of contamination is not delineated / remediated.
2. Background Substances – Background concentrations in surface water, sediments or vapour were derived by any methods.
3. Involving Orders – If the site is subject to a remediation order, pollution prevention order or pollution abatement order under the Act
4. Greater than 5 year Approval in Principle
6. Risk Assessment with:
 - a. Modification of toxicity reference values
 - b. Derivation or use of a site-specific risk-based concentration
 - c. SLRA at high risk sites

PRE-APPROVAL & DIRECTORS DECISION

Items to consider for 6 Pre-approval situations

1. **Delineation – Full extent of contamination is not delineated / remediated.**
 - **Fact Sheet 16 – Remediation Liability Overview** – Details the Ministry's expectations of who is responsible for what
 - **Procedure 6: Establishing the Boundaries of a Site** – Provides guidance on how the Ministry expects boundaries to be established.
 - **Admin Guidance 11** – Expectations and Requirements for Contaminant Migration – Speaks to boundary issues and how to communicate with off-site impacted owners.

PRE-APPROVAL & DIRECTORS DECISION

Items to consider for 6 Pre-approval situations

2. Background Substances – Background concentrations in surface water, sediments or vapour were derived by any methods.

3. Involving Orders – If the site is subject to a remediation order, pollution prevention order or pollution abatement order under the Act

None to date.

4. Greater than 5 year Approval in Principle

None listed, but has been done. Provide rationale (new owners,

PRE-APPROVAL & DIRECTORS DECISION

Items to consider for 6 Pre-approval situations

5. Risk Assessment with:

- a. Probabilistic analysis
- b. Toxicity test
- c. Modification of toxicity reference values
- d. Derivation or use of a site-specific risk-based concentration.

Quite a number of these have been issued to date and have included:

- Probabilistic RA, toxicity testing, food chain modeling, modification of TRVs, weight of evidence arguments
- Still no site specific risk based concentrations

DRAFT CoC INSTRUMENT

~ Bob Symington

DRAFT INSTRUMENTS – CERTIFICATE OF COMPLIANCE

New Templates issued
and available on the CSAP
Website. Check you are
using the current ones.

May 7, 2018

Date Issued

Site Identification Number 21403
Version 9.0 R

 Ministry of
Environment and
Climate Change Strategy

CERTIFICATE OF COMPLIANCE
(Pursuant to Section 53 of the *Environmental Management Act*)

THIS IS TO CERTIFY that as of the date indicated below, the site identified in Schedule A of this Certificate of Compliance has been satisfactorily remediated to meet the applicable Contaminated Sites Regulation remediation standards and criteria.

This Certificate of Compliance is qualified by the requirements and conditions specified in Schedule B.

The substances for which remediation has been satisfactorily completed and for which this Certificate of Compliance is valid are listed in Schedule C.

I have issued this Certificate of Compliance based on a review of relevant information including the documents listed in Schedule D. I, however, make no representation or warranty as to the accuracy or completeness of that information.

A Director may rescind this Certificate of Compliance if requirements and conditions imposed in the Certificate of Compliance are not complied with or any fees payable under Part 4 of the Act or regulations are outstanding.

This Certificate of Compliance should not be construed as an assurance that there are no hazards present at the site.

May 7, 2018
Date Issued

J.A. Brooke
For Director, *Environmental Management Act*

Site Identification Number 21403
Version 9.0 R

1 of 6

DRAFT INSTRUMENTS – CERTIFICATE OF COMPLIANCE

Affected Parcel Instruments

Last paragraph of cover page of Instrument

“The substances to which this Certificate of Compliance applies migrated to the site from a neighbouring source. It should not be assumed that this Certificate of Compliance certifies the remediation of all contaminants at the site. “

DRAFT INSTRUMENTS – CERTIFICATE OF COMPLIANCE

Schedule A

If metes and bounds, this
should be described here

Schedule A

The lands covered by this Certificate of Compliance are located adjacent to and northeast of 1314-1348 Southwest Marine Drive, Vancouver BC, which is more particularly known and described as:

Commencing at the northeast corner of Lot 6, Block 1, Plan 2067, District Lot 318, NWD Lot 7, Block 1, Plan 2067, District Lot 318, New Westminster Land District;
Then N 61° 13' 09.77" W 0.939m;
Then N 61° 13' 09.77" W 21.61m;
Then S 73° 10' 38.78 E 7.916m;
Then S 61° 11' 51.54 E 13.867m;
Then S 28° 48' 08.46" W 1.683m to point of commencement.

The approximate centre of the site using the NAD (North American Datum) 1983 convention is:

Latitude: 49° 12' 11.82"
Longitude: 123° 08' 9.27"

Schedule A

The site covered by this Certificate of Compliance is located at 1314-1348 Southwest Marine Drive, Vancouver BC, which is more particularly known and described as:

Lot 4, Block 1, District Lot 318, Plan 2067, New Westminster Land District
PID: 014-052-113

Lot 5, Block 1, District Lot 318, Plan 2067, New Westminster Land District
PID: 014-052-121

Lot 6, Block 1, District Lot 318, Plan 2067, New Westminster Land District
PID: 014-052-130

Lot 7, Block 1, District Lot 318, Plan 2067, New Westminster Land District
PID: 014-052-148

Lot 8, Block 1, District Lot 318, Plan 2067, New Westminster Land District
PID: 014-052-156

Lot 9, Block 1, District Lot 318, Plan 2067, New Westminster Land District
PID: 014-052-164

The approximate centre of the site using the NAD (North American Datum) 1983 convention is:

Latitude: 49° 12' 11.33"
Longitude: 123° 08' 10.30"

DRAFT INSTRUMENTS – CERTIFICATE OF COMPLIANCE

Schedule A

Scale Bar

North Arrow

Bold Line

Can you drive to it?

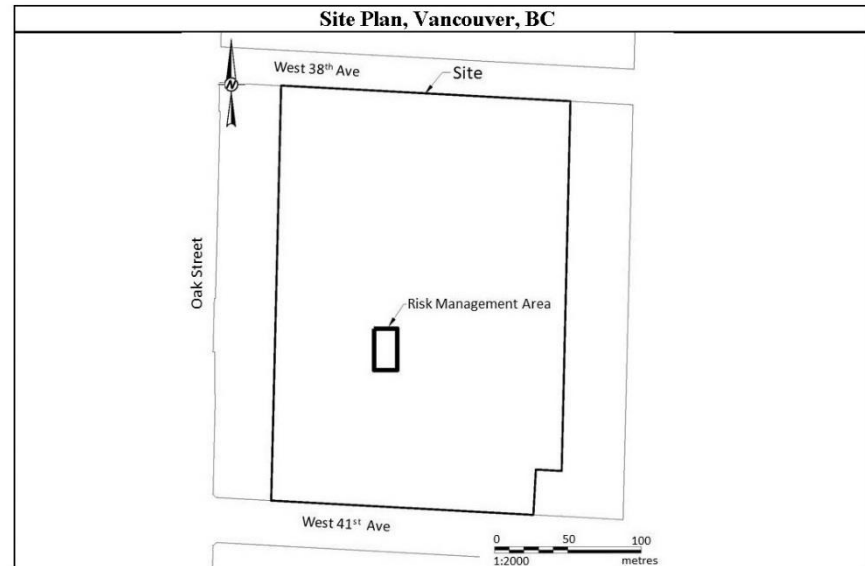

DRAFT INSTRUMENTS – CERTIFICATE OF COMPLIANCE

Schedule B Condition 1

1. Any changes in land, vapour, or water uses must be promptly identified by the responsible person in a written submission to the Director. An application for an amendment or new Certificate of Compliance may be necessary. The uses to which this condition applies are described in Schedule C and in the site investigation documents listed in Schedule D.

The documents listed in Schedule D indicate that vapour attenuation factors were applied to meet Contaminated Sites Regulation numerical standards at the site. These vapour attenuation factors were selected based on assumptions about the structures, locations and depths of buildings existing or expected at the site. These assumptions include the following:

- (a) Future high density residential buildings will be slab-at-grade, or
- (b) Future high density residential buildings will be constructed with one level of underground parkade.

Any inconsistencies that arise between the structures, locations and depths of proposed or constructed buildings at the site and the range of structures, locations and depths of buildings assumed in the selection of vapour attenuation factors in the documents listed in Schedule D must be promptly identified by the responsible person in a written submission to the Director. An application for an amendment or new Certificate of Compliance may be necessary.

DRAFT INSTRUMENTS – CERTIFICATE OF COMPLIANCE

Schedule B Condition 2

2. The principal risk controls which must be present or implemented and must be maintained at the site include the following:
 - (a) Groundwater from the site will not be used as a source of drinking water.
 - (b) The maintenance of a minimum of 1 m of uncontaminated material or a cap/cover over the risk management area, as shown in the Site Plan and described by the following metes and bounds.

COMMENCING AT THE SOUTHWESTERLY CORNER OF PLAN VAP7764, DISTRICT LOT 526, NEW WESTMINSTER, BLOCK 866, EXCEPT PART IN REFERENCE PLAN 15238, THENCE NORTH 38.2° EAST, A DISTANCE OF 113.180 METRES TO THE POINT OF COMMENCEMENT;
THENCE NORTH, A DISTANCE OF 28.073 METRES

DRAFT INSTRUMENTS – CERTIFICATE OF COMPLIANCE

Schedule C - Listing of Substances Soils

Substances remediated in soil for commercial land soil use:

To meet numerical remediation standards:

naphthalene	91-20-3	VPH	NA
selenium	7782-49-2		

To meet risk based standards:

antimony	7440-36-0	HEPHs	NA
arsenic	7440-38-2	lead	7439-92-1
benz(a)anthracene	56-55-3	LEPHs	NA
benzo(b+j)fluoranthenes	205-82-3	manganese	7439-96-5
cadmium	7440-43-9	mercury	7439-97-6
chromium	7440-47-3	nickel	7440-02-0
cobalt	7440-48-4	tin	7440-31-5
copper	7440-50-8	zinc	7440-66-6
indeno(1,2,3-cd)pyrene	193-39-5		

DRAFT INSTRUMENTS – CERTIFICATE OF COMPLIANCE

Schedule C - Listing of Substances Water

Substances remediated in water for marine aquatic life water use:

To meet numerical remediation standards:

acenaphthene	83-32-9	naphthalene	91-20-3
acridine	260-94-6		

To meet risk based standards:

anthracene	120-12-7	phenanthrene	85-01-8
fluoranthene	206-44-0	pyrene	129-00-0
LEPHw	NA		

DRAFT INSTRUMENTS – CERTIFICATE OF COMPLIANCE

Schedule C - Listing of Substances Vapour

Substances remediated in soil vapour for parkade land vapour use:

To meet risk based standards:

benzene	71-43-2	naphthalene	91-20-3
---------	---------	-------------	---------

DRAFT **DETERMINATIONS**

~ James Smith

DRAFT INSTRUMENTS – DETERMINATION

- Draft generated by submission manager
- Requires edits, mostly if/not contaminated and to Substances.



Ministry of
Environment and
Climate Change Strategy

FINAL DETERMINATION (Pursuant to Section 44 of the *Environmental Management Act*)

I have made a Final Determination that the site identified in Schedule A of this document is **not** a contaminated site.

This Final Determination is qualified by the requirements and conditions specified in Schedule B. |

The site does not have concentrations of the substances specified in Schedule C that exceed the applicable standards and criteria prescribed in the Contaminated Sites Regulation for determining whether a site is a contaminated site.

I have issued this Final Determination based on a review of relevant information including the documents listed in Schedule D. I, however, make no representation or warranty as to the accuracy or completeness of that information.

This Final Determination should not be construed as an assurance that there are no hazards present at the site.

Date Issued

Site Identification Number <Site ID>
Version 9.0 R

Signing Authority
For Director, *Environmental Management Act*

1 of 10

DRAFT INSTRUMENTS – DETERMINATION

Schedule A

- Generated by submission manager
- If metes and bounds, this should be described here

Schedule A	
The site covered by this Final Determination is located at 2555 Cedar Mountain Road, Vancouver, British Columbia> which is more particularly known and described as:	
Amended Lot 9 (See 1212878L) Block 3455 District Lot 256 Plan VAP 590 PID: 015-994-184 2555 Cedar Mountain Road	
The approximate centre of the site using the NAD (North American Datum) 1983 convention is:	
Latitude:	49° 15' 47.50"
Longitude:	123° 7' 45.00"
Date Issued	Signing Authority For Director, <i>Environmental Management Act</i>
Site Identification Number <Site ID> Version 9.0 R	

DRAFT INSTRUMENTS – DETERMINATION

Schedule A continued

- Follow rules regarding figures

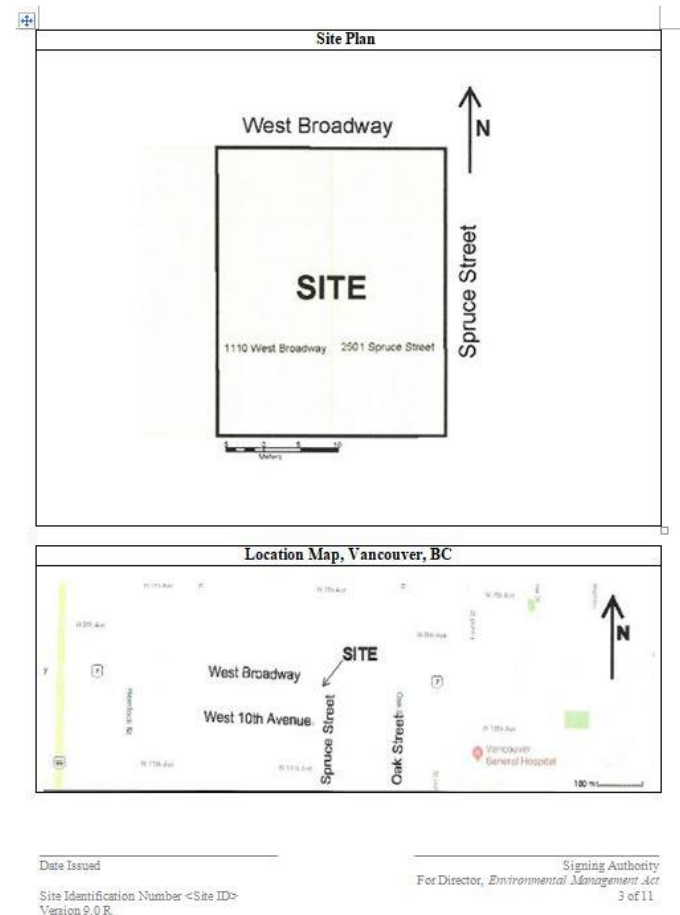

DRAFT INSTRUMENTS – DETERMINATION

Schedule B

- Use the ENV templates
- Edit according to determination conditions
- The signing director will read this schedule!

Schedule B Requirements and Conditions

1. Any changes in land, vapour, or water use must be promptly identified by the responsible person in a written submission to the Director. An application for an amendment or new Determination of Contaminated Site may be necessary. The uses to which this condition applies are described in Schedule C and in the site investigation documents listed in Schedule D.

The documents listed in Schedule D indicate that vapour attenuation factors were applied to meet Contaminated Sites Regulation numerical standards at the site. These vapour attenuation factors were selected based on assumptions about the structures, locations and depths of buildings existing or expected at the site. These assumptions include the following:

(a) "A slab-on-grade building will cover the entire site";

Any inconsistencies that arise between the structures, locations and depths of proposed or constructed buildings at the site and the range of structures, locations and depths of buildings assumed in the selection of vapour attenuation factors in the documents listed in Schedule D must be promptly identified by the responsible person in a written submission to the Director. An application for an amendment or new Determination of Contaminated Site may be necessary.

Date Issued _____
Site Identification Number <Site ID>
Version 9.0 R

Signing Authority
For Director, Environmental Management Act
3 of 11

DRAFT INSTRUMENTS – DETERMINATION

Schedule C

- Use the ENV templates
- Follow the rules!
 - Organize alphabetically
 - Separate by media use
 - Use regulated names
 - Include CAS #

Schedule C

Substances and Uses

Substances evaluated in soil for commercial land soil use:

To meet numerical standards prescribed for defining whether a site is contaminated:

acenaphthene	83-32-9	dichloroethane, 1,2-	107-06-2
anthracene	120-12-7	dichloroethylene, 1,1-	75-35-4
antimony	7440-36-0	dichloroethylene, 1,2-cis	156-59-2
arsenic	7440-38-2	dichloroethylene, 1,2-trans	156-60-5
barium	7440-39-3	dichloromethane	75-09-02
benz[a]anthracene	56-55-3	dichloropropane, 1,2-	78-87-5
benzene	71-43-2	dichloropropene, 1,3- (cis+trans)	542-75-6
benzo(a)pyrene	50-32-8	ethylbenzene	100-41-4
benzo(b)fluoranthene	205-99-2	ethylene glycol	107-21-1
benzo(k)fluoranthene	207-08-9	fluoranthene	206-44-0
beryllium	7440-41-7	fluorene	86-73-7
bromodichloromethane	75-27-4	HEPHs	NA
bromoform	75-25-2	indeno(1,2,3-cd)pyrene	193-39-5
cadmium	744-43-9	lead	7439-92-1
carbon tetrachloride	56-23-5	LEPHs	NA
chlorobenzene	108-90-7	mercury	7439-97-6
chloroform	67-66-3	methyl tert-butyl ether	1634-04-4
chromium	7440-47-3	methylnaphthalene, 2-	91-57-6
chrysene	218-01-9	molybdenum	7439-98-7
cobalt	7440-48-4	naphthalene	91-20-3
copper	7440-50-8	nickel	7440-02-0
dibenz[a,h]anthracene	53-70-3	phenanthrene	85-01-8
dibromochloromethane	124-48-1	pyrene	129-00-0
dichlorobenzene, 1,2-	95-50-1	selenium	7782-49-2
dichlorobenzene, 1,3-	541-73-1	silver	7440-22-4
dichlorobenzene, 1,4-	106-46-7	styrene	100-42-5
dichloroethane, 1,1-	75-34-3	tetrachloroethane, 1,1,1,2-	630-20-6

DOCUMENTATION

- Land Title
- Legal Plans
- Road Dedications and Boundary Issues

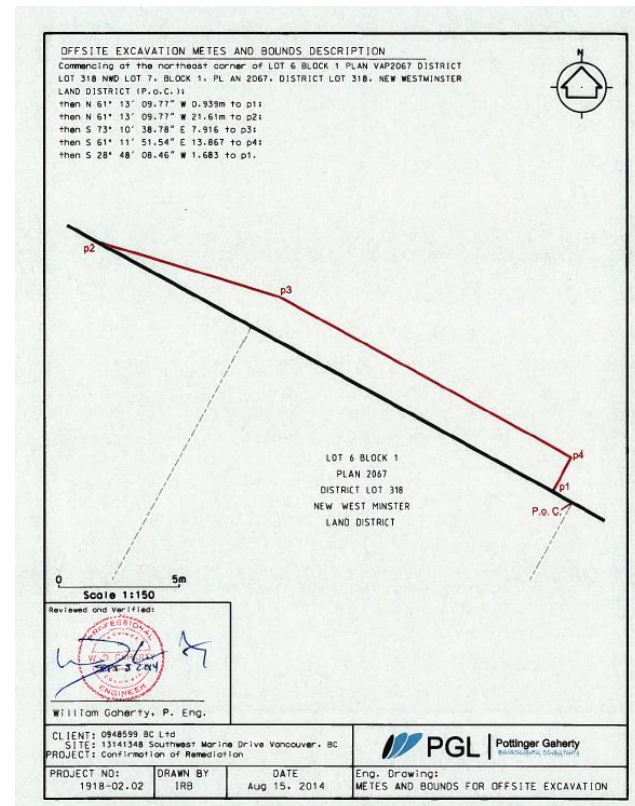

BOREHOLE LOG TEMPLATE

~ James Smith

BOREHOLE LOG TEMPLATE

- Only one representative log required
- Use most recent XL version
- Some cells are locked
- Use drop down menus

							LATITUDE			LONGITUDE			Date of Installation			BH Log Document Name (please use this name for your BH Log file)
Example Data: Borehole Name	Site Address	Site Municipality	BH Total Depth	Top of MW Pipe Elevation	Ground Surface Elevation	MOE Site ID	Deg °	Mins '	Sec "	Deg °	Mins '	Sec "	Day	Month	Year	
MW2008-1	5433 Bridge Street	Vancouver	29.3	7.2	6.57	3100	49	34	7	123	45	11	13	Mar	2009	3100_MW2008-1.pdf
Please enter your borehole information below:							LATITUDE			LONGITUDE			Date of Installation			BH Log Document Name (please use this name for your BH Log file)
Borehole Name	Site Address	Site Municipality	BH Total Depth (mbgs)	Top of MW Pipe Elevation (masl preferred)	Ground Surface Elevation (masl preferred)	MOE Site ID	Deg °	Mins '	Sec "	Deg °	Mins '	Sec "	Day	Month	Year	

*use drop downs

BOREHOLE LOG TEMPLATE

- Only one representative log required
- Use most recent XL version
- Some cells are locked
- Use drop down menus

Example: Lithologic UNIT Number	Depth to Top of UNIT	Depth to Bottom of UNIT	UNIT Description	Screened Interval TOP Depth	Screened Interval BOTTOM Depth	Hydraulic Conductivity	Depth to Groundwater (Top of MW Pipe)
1	0.00	5.20	Fill				
2	5.20	14.00	Poorly graded sand				
3	14.00	19.20	Sand and gravel				
4	19.20	29.00	Poorly graded gravel	27.10	28.60	0.03	22.260
5	29.00	29.30	Inorganic clay - high plasticity				
Please enter your Borehole Lithology information below:							
Lithologic UNIT Number (Automatically Generated)	Depth to Top of UNIT (Automatically Generated)	Depth to Bottom of UNIT	Lithologic UNIT Description	Screened Interval TOP Depth (Note screen depths on associated Unit row)	Screened Interval BOTTOM Depth	Hydraulic Conductivity (m/s) (Note on screened Unit row)	Depth to Groundwater (m) (measured from Top of MW Pipe) (Note depth on screened Unit row)
1	0.00	2.50	Gravel, clayey Clay, gravelly				

SITE SITE RISK CLASSIFICATION

~ Lori Larsen

SITE RISK CLASSIFICATION

Relevant ENV Documents:

- **Protocol 12:** Site Risk Classification, Reclassification and Reporting
- **Protocol 11:** Upper Cap Concentration of Substances

Other References:

- **Protocol 16:** Determining the Presence of Mobility of NAPL and Odourless Substances
- **Protocol 11:** Ministry Response to Comments
- **Fact Sheet 45:** Site Risk Classification

SITE RISK CLASSIFICATION

Protocol 12: Site Risk Classification, Reclassification and Reporting

- OBJECTIVE: Determine if Site is HIGH RISK
- HIGH RISK is when either one or both of two conditions exist:
 1. Mobile NAPL is present (Protocol 16)
 2. Upper Cap Concentrations are
 - a) exceeded and
 - b) exposure pathway present
- If the Site is classified as High Risk you can only submit it for an instrument with BC ENV pre-approval.
- The classification is based upon current conditions, but you also must consider the proposed use.

SITE RISK CLASSIFICATION

Protocol 11: Upper Cap Concentration of Substances

Provides upper cap concentrations for:

- **Table 1.** Human Health Intake of Contaminated Soil, Upper Cap Concentrations for Schedule 3.1 Part 1 Substances
- **Table 2.** Ecological Health Toxicity to Soil Invertebrate and Plants, Upper Cap Concentrations for Schedule 3.1 Part 1 Substances¹
- **Table 3.** Ecological Health Livestock Ingesting Soil and Fodder, Upper Cap Concentrations for Schedule 3.1 Part 1 Substances
- **Table 4.** Human Health Intake of Contaminated Soil, Upper Cap Concentrations for Schedule 3.1 Part 2 Substances
- **Table 5.** Ecological Health Soil Invertebrate and Plants Exposure Upper Cap Concentrations for Schedule 3.1 Part 3 Substances

SITE RISK CLASSIFICATION

Protocol 11: Upper Cap Concentration of Substances

Provides upper cap concentrations for:

- **Table 6.** Water Upper Cap Concentrations for Schedule 3.2 Substances
- **Table 7.** Human Health Vapour Exposure Upper Cap Concentrations for Schedule 3.3 Substances
- **Table 8.** Environmental Health Aquatic Life Sediment Exposure Upper Cap Concentrations for Schedule 3.4 Substances

SITE RISK CLASSIFICATION

Trigger to Submit Site Risk Classification Report (SRCR) for applications for a legal instrument (CSAP):

- Protocol 12: Table 1, Column 1, #4
 - Application to a Director for a contaminated sites service in Table 2 or 3 of Schedule 3 of the Regulation

Timing:

- At the time the application for a contaminated sites service is submitted

Persons with the Duty to Submit Site Risk Classification Information:

- The applicant for the associated contaminated sites service

SITE RISK CLASSIFICATION

Table 1. Notification triggers and timing for submission of site risk classification information

Column I	Column II	Column III	Column IV	Column V
No.	Notification Trigger	Timing for Submission of Site Risk Classification Information	Persons with the Duty to Submit Site Risk Classification Information	Notes
1	Submission of a Notification of Initiation of Independent Remediation to a Director	At the time the Notification of Initiation of Independent Remediation initiation is submitted	The person with the duty to submit the associated Notification of Initiation of Independent Remediation	1
2	Submission of a site investigation report required or ordered by a Director	At the time the site investigation report is submitted	The person required or ordered by the Director to submit the associated site investigation report	1
3	Submission of a Notification of Likely or Actual Migration to a Director	At the time the Notification of Likely or Actual Migration is submitted	The person with the duty to submit the associated Notification of Likely or Actual Migration	1
4	Application to a Director for a contaminated sites service in Table 2 or 3 of Schedule 3 of the Regulation	At the time the application for a contaminated sites service is submitted	The applicant for the associated contaminated sites service	2
5	Imposition by a Director of the requirement for a Site Risk Classification Report submission	At the time the Director has specified for the submission	The person on whom the Director imposes the requirement for the Site Risk Classification Report	
6	Potential or actual high risk conditions at a neighbouring parcel are indicated in the Site Risk Classification Report submitted to a Director for a parcel under any of the preceding triggers	At the time the Site Risk Classification Report is submitted for the source site	The person who has the duty to submit a Site Risk Classification Report under any of triggers 1 – 5	1, 3

SITE RISK CLASSIFICATION

Protocol 12 Reporting Exemptions:

- Trigger does not apply to oil and gas sites administered by the Oil and Gas Commission classified as “non-priority”
- When two or more “triggers” exist under Table 2 – only one report needed.
- When a report has already been submitted to BC ENV within the past five years ...but...
 - If there is new information the report must be submitted
- Determination of no contamination

SITE RISK CLASSIFICATION

Protocol 12 Reporting Exemptions continued

- Independent remediation where the quantity of soil to be remediated does not exceed 5 cubic metres in volume during the entire course of remediation at the site.
- Residential Heating Oil Tanks
 - a) No NOM;
 - b) Only petroleum hydrocarbons in residential heating oil;
 - c) Sites which are not high risk sites;
 - d) Land used for residential land use; and
 - e) UST with a volume $\leq 2\,500$ litres has been or will be removed.
- Emergency Response to a Spill
 - This exemption is applicable only if the spill has been reported in accordance with the requirements of the Spill Reporting Regulation under the Act.

DOCUMENTATION

~ James Smith, Bob Symington, and
Paul Webb

DOCUMENTATION

- Land Title
- Legal Plans
- Road Dedications and Boundary Issues

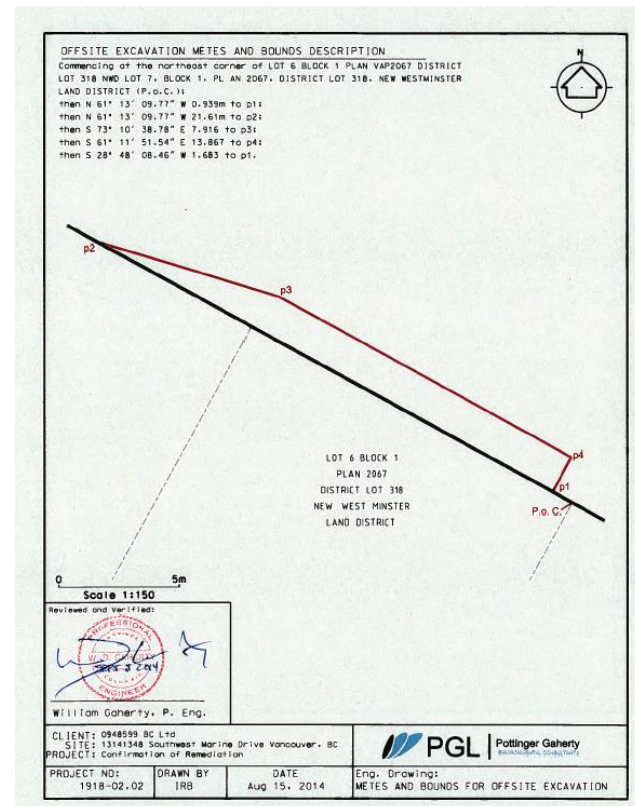

DOCUMENTATION

- Site registry searches
- PSI/DSI checklists (TG10 & 11)
- Include NOIR and NOCIR
- AG11 – Notify affected parcel about public records

10
TECHNICAL GUIDANCE
ON CONTAMINATED SITES

This checklist is used in combination with Technical Guidance 10.

SITE:					
GENERAL TOPIC	#	Points of Review (Stage 1 PSI)	Reference	Applicability	Notes
RELEVANCE	1	Were the Stage 1 PSI historical searches and site visit completed within 6 months of the CSAP review; or, if not, does the investigator provide a clear statement that onsite and offsite land uses have remained substantially the same?		Yes	
AUTHORS AND RELIANCE	2	Does the investigator identify who the major participants are in the investigation and state his/her qualifications?	CSR S. 63	Yes	
	3	Does the report or cover letter provide reliance of the report to the Ministry?		Yes	
METHODS AND PROCEDURE	4	Does the investigator follow CSR methodology and procedure to complete the Stage 1 PSI?	CSR S 58(1a)	Yes	
SUBJECT SITE DESCRIPTION	5	Has the investigator provided:		Yes	
	a	site information (e.g., civic address and legal description, etc.) as required in SoSC;		Yes	
	b	current municipal zoning of subject site;	CSSAF	Yes	
	c	approved (i.e. as identified on an Official Community Plan) municipal zoning of subject site;		If available	If there is a change in the zoning anticipated (find reference).

11
TECHNICAL GUIDANCE
ON CONTAMINATED SITES

This checklist is used in combination with Technical Guidance 11.

SITE:					
GENERAL TOPIC	#	Points of Review (Stage 2 PSI and DSI)	Reference	Applicability	Notes
AUTHORS AND RELIANCE	1	Does the investigator identify who the major participants are in the investigation and state his/her qualifications?	CSR S. 63	Yes	
	2	Does the report or cover letter provide reliance of the report to the Ministry?		Yes	
PROBLEM DEFINITION	3	Has the investigator:			
General	a	provided site information (e.g., civic address and legal description, etc.) as required in SoSC;		Yes	
	b	listed, reviewed, summarized and interpreted data from relevant previous environmental (investigation and remediation) and geotechnical reports, and identified information and data that was relied upon for assessment of site conditions?		If available	
	c	provided a clear rationale for changes to APEC or PCOC indicated in the Stage 1 PSI?		Yes, if applicable	
Context	4	Does the investigator describe the relationship of the subject site to the surrounding area?	CSR S8(5) and (6)		

AG11 Communications

- **ADMINISTRATIVE GUIDANCE 11 CSAP Communications Template**
- **ADMINISTRATIVE GUIDANCE 11 COMMUNICATION RECORD**

CSAP Members Area

Welcome, members! You can complete the following tasks through the CSAP Submissions Manager:

- Make a CSS application
- Track submission progress
- Find instrument templates
- Track professional development hours

Submission Guidelines

CSAP Transmittal Letter (submit Word version)

ENV SoSC Form	CSAP Annotated SoSC
ENV SoSC Form	CSAP Annotated SoSC
** Please use this form when submitting.	** Please refer to this Annotated version as a guide when completing the ENV SoSC Form.

CSAP AG 11 Communications Template (doc)

Arms Length Review of Submission Template (doc 38kb)

ENV Borehole Form (excel spreadsheet)

CSAP Screening List

Ministry Forms

ENV Administrative Bulletin 3: Omnibus Amendment Transition 2016-2017



Find a CSAP



Make a Submission



Pay Fees

www.csapsociety.bc.ca | ©

AG11 Communication Record

ADMINISTRATIVE GUIDANCE 11: COMMUNICATION RECORD

Project Number: 0987-01

Site Address: 1234 Any Street, Victoria, BC

Client: Five W Co.

Affected Parcel Owner	Address	Date Notification of Likely or Actual Migration (NOM) was received by BC MOE and Affected Parcel
Property Owners: John and Jane Doe 1234 Any Street, Victoria BC V9T 1S4 Tel: 250-515-7777 Email: jdoe@hotmail.com	1234 Any Street, Victoria, BC	August 23, 2017 NOM and SRCR for 1234 Any St. – submitted by ABC Consulting Ltd.

Contact Details	Date	Type of Communication	Details Discussed
Property Owner: John Doe	22-July-17	Registered Mail	Notification of Contamination letter, Draft CoC
Property Owner: John Doe	25-Aug-17	In Person – P. Quigley	Notification of Contamination letter, Draft CoC
Property Owner: John Doe	13-Sep-17	Email – R. Guthrie	Notification of Contamination letter, Draft CoC clauses explained

QUESTIONS?

We'd like to thank James, Lori and Paul for their time and hard work.

THANK YOU FOR YOUR PARTICIPATION

Please look for information on our next webinar:
“Submissions Manager Walkthrough ”
Nov.20th, 2018