



Ministry of
Environment

PRELIMINARY DETERMINATION
(Pursuant to Section 44 of the *Environmental Management Act*)

I have made a Preliminary Determination that the site identified in Schedule A of this document is **not** a contaminated site.

This Preliminary Determination is qualified by the requirements and conditions specified in Schedule B.

The site **does not have** concentrations of the substances specified in Schedule C that exceed the applicable standards and criteria prescribed in the Contaminated Sites Regulation for determining whether a site is a contaminated site.

I have issued this Preliminary Determination based on a review of relevant information including the documents listed in Schedule D. I, however, make no representation or warranty as to the accuracy or completeness of that information.

This is to advise that I will consider submissions received 35 days after delivery of this Preliminary Determination before a Final Determination is made.

In accordance with the *Environmental Management Act*, I will notify persons with an interest in the subject site once a Final Determination is made.

This Preliminary Determination should not be construed as an assurance that there are no hazards present at the site.

Oct. 16/14
Date Issued



J.A. Brooke
For Director, *Environmental Management Act*

Schedule A

The site covered by this Preliminary Determination is located at 23054 Lougheed Highway, Maple Ridge, British Columbia which is more particularly known and described as:

Lot 32 District Lots 402 and 403 Group 1 New Westminster District Plan 61595

PID: 002-818-477

The approximate centre of the lands using the NAD (North American Datum) 1983 convention is:

Latitude:	49°	12'	27.2"
Longitude:	122°	35'	8.33"

Oct. 16/14
Date Issued

SITE Identification Number 16477
Version 8.0 R

J. Brooke
J.A. Brooke
For Director, *Environmental Management Act*
2 of 7

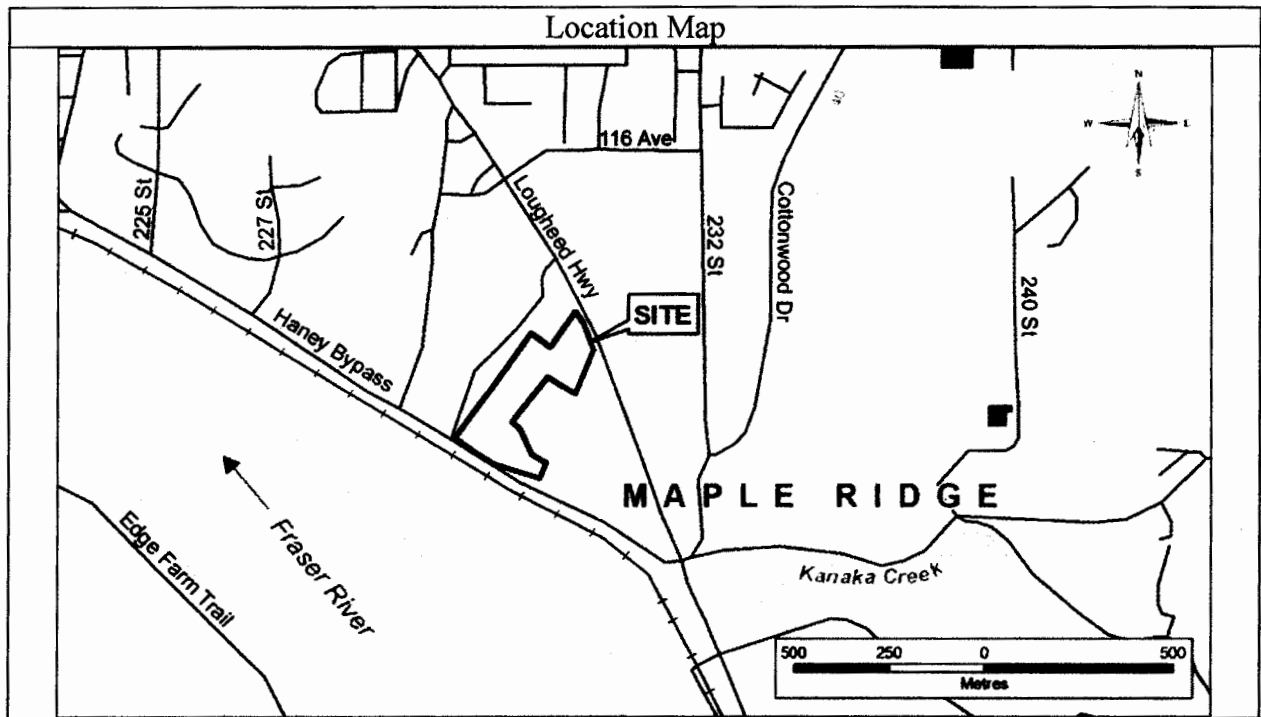
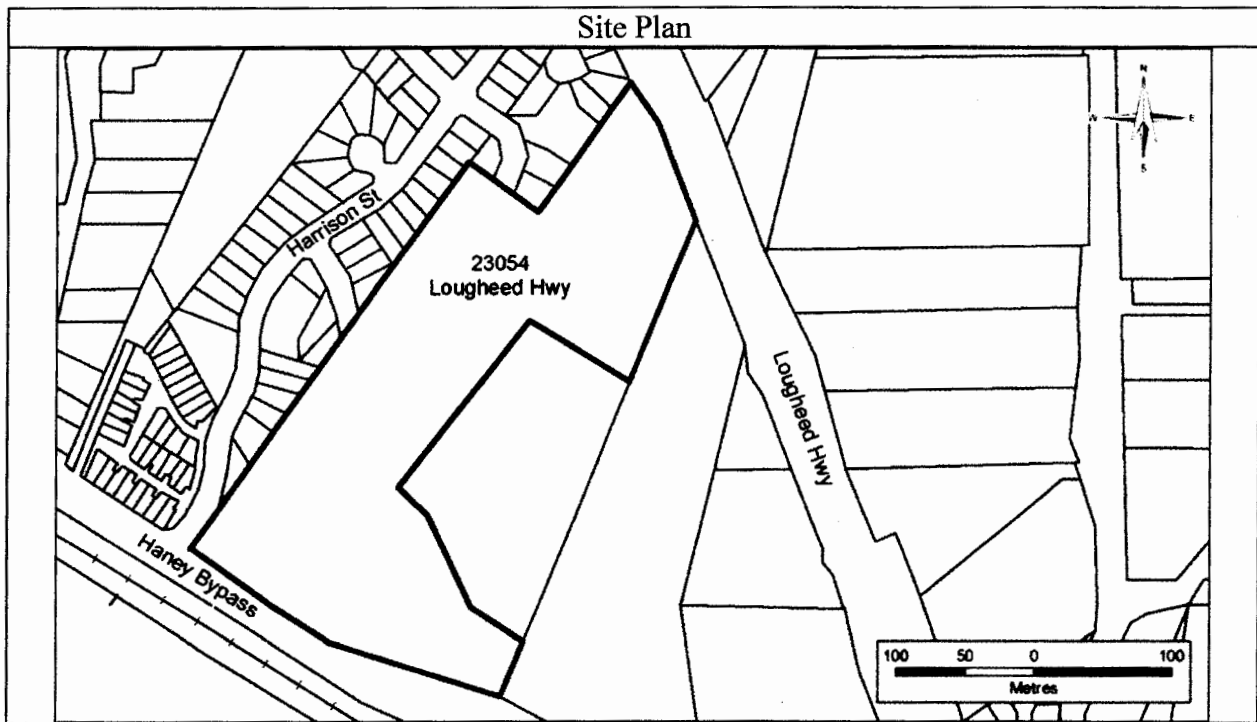

Oct. 16/14
Date Issued

SITE Identification Number 16477
Version 8.0 R

J.A. Brooke
For Director, *Environmental Management Act*

Schedule B

Requirements and Conditions

This Schedule contains no requirements or conditions.

Oct. 16/14
Date Issued

SITE Identification Number 16477
Version 8.0 R

J. Brooke
J.A. Brooke
For Director, *Environmental Management Act*
4 of 7

Schedule C

Substances and Uses

Substances evaluated in soil for urban park soil use:

To meet numerical remediation standards prescribed for defining whether a site is contaminated:

- Antimony, arsenic, barium, beryllium, cadmium, cobalt, copper, lead, manganese, mercury, molybdenum, nickel, selenium, silver, tin, uranium, vanadium and zinc;
- Benz[a]anthracene, benzo[a]pyrene, benzo[b]fluoranthene, benzo[k]fluoranthene, dibenz[a,h]anthracene, indeno [1,2,3-cd] pyrene, naphthalene, phenanthrene, and pyrene;
- Benzene, ethylbenzene, styrene, toluene and xylene;
- Chromium (+3), chromium (+6) and chromium (total); and
- HEPHs, LEPHs, and methyl tert-butyl ether (MTBE).

Substances evaluated in soil for residential land soil use:

To meet numerical remediation standards prescribed for defining whether a site is contaminated:

- Antimony, arsenic, barium, beryllium, cadmium, cobalt, copper, lead, manganese, mercury, molybdenum, nickel, selenium, silver, tin, uranium, vanadium and zinc;
- Benz[a]anthracene, benzo[a]pyrene, benzo[b]fluoranthene, benzo[k]fluoranthene, dibenz[a,h]anthracene, indeno [1,2,3-cd] pyrene, naphthalene, phenanthrene, and pyrene;
- Benzene, ethylbenzene, styrene, toluene and xylene;
- Chromium (+3), chromium (+6) and chromium (total); and
- HEPHs, LEPHs and methyl tert-butyl ether (MTBE).

Substances evaluated in water for drinking water use:

To meet numerical remediation standards prescribed for defining whether a site is contaminated:

- Benzo[a]pyrene;
- Aluminum, antimony, arsenic, barium, boron, cadmium, chloride, chromium, copper, fluoride, lead, magnesium, mercury, molybdenum, nitrate (as N), nitrate and nitrite (as N), nitrite (as N), selenium, sodium, sulphate, uranium and zinc;
- Benzene, ethylbenzene, toluene, and xylenes (total); and
- EPH_{w10-19}, methyl tert-butyl ether (MTBE) and VH_{w6-10}.

Oct. 16/14
Date Issued

SITE Identification Number 16477
Version 8.0 R



J.A. Brooke
For Director, *Environmental Management Act*

5 of 7

Substances evaluated in water for freshwater aquatic life water use:

To meet numerical remediation standards prescribed for defining whether a site is contaminated:

- Acenaphthene, acridine, anthracene, benzo[a]anthracene, benzo[a]pyrene, chrysene, fluoranthene, fluorene, naphthalene, phenanthrene, pyrene and quinoline;
- Ammonia, antimony, arsenic, barium, beryllium, boron, cadmium, chloride, chromium, cobalt, copper, fluoride, lead, mercury, molybdenum, nickel, nitrate (as N), nitrate and nitrite (as N), nitrite (as N), selenium, silver, sulphate, thallium, titanium, uranium and zinc;
- Benzene, ethylbenzene and toluene;
- Chromium III and chromium VI; and
- EPH_{w10-19}, LEPH_w, methyl tert-butyl ether (MTBE), VH_{w6-10} and VPH_w.

Substances evaluated in sediment for freshwater sensitive sediment use:

To meet numerical remediation standards prescribed for defining whether a site is contaminated:

- Chromium (total).

Oct. 16/14
Date Issued

SITE Identification Number 16477
Version 8.0 R



J.A. Brooke
For Director, *Environmental Management Act*
6 of 7

Schedule D

Documents

- *Addendum Letter – Determination Application, 23054 Lougheed Highway, Maple Ridge, BC, Site ID# 16477*, prepared by Brant Dorman, Tetra Tech EBA, dated September 2014;
- *Summary of Site Condition*, prepared by Brant Dorman, Tetra Tech EBA, dated September 22; 2014;
- *Stage 2 Preliminary Site Investigation/ Detailed Site Investigation Conclusions and Determination of Status Application*, prepared by Lora Paul and Brant Dorman, Tetra Tech EBA, dated June 2014;
- *Stage 1 Preliminary Site Investigation Update Addendum*, prepared by Carol Ma and Lora Paul / Tetra Tech EBA, dated June 2014;
- *Application for Local Background Groundwater Concentration Determination at 23054 and 23060 Lougheed Highway, Maple Ridge, BC*, prepared by Peggy Evans, BC Ministry of Environment, dated May 2014;
- *Protocol 9 Determination Addendum for Elevated Groundwater Chromium Concentrations at 23054 and 23060 Lougheed Highway, Maple Ridge, BC*, prepared by Martin Jarman and Brant Dorman / Tetra Tech EBA, dated April 2014;
- *Protocol 9 Pre-Approval for Elevated Groundwater Chromium Concentrations at 23054 and 23060 Lougheed Highway, Maple Ridge, BC*, prepared by Martin Jarman and Brant Dorman / Tetra Tech EBA, dated March 2014;
- *Stage 2 Preliminary Site Investigation and Detailed Site Investigation, 23054 and 23060 Lougheed Highway, Maple Ridge, BC*, prepared by Terry Fulton, Carol Ma, Lora Paul and Brant Dorman / Tetra Tech EBA, dated March 2014;
- *Protocol 9 Pre-Approval for Elevated Groundwater Chromium Concentrations at 23054 and 23060 Lougheed Highway, Maple Ridge, BC*, prepared by Martin Jarman and Brant Dorman / Tetra Tech EBA, dated March 2014;
- *Stage 1 Preliminary Site Investigation*, prepared by Timo Hess, Terry Fulton, Sharon Basit and Brant Dorman / EBA Engineering Consultants Ltd., operating as EBA, a Tetra Tech Company, dated Feb 2013; and
- *Ministry of Transportation, Maple Ridge Properties, Environmental Assessment*, prepared by Coast River Environmental Services Ltd. for the Ministry of Transportation Environmental Services Section, dated September 2005.

Oct. 16/14
Date Issued

SITE Identification Number 16477
Version 8.0 R



J.A. Brooke
For Director, *Environmental Management Act*

7 of 7