



**CERTIFICATE OF COMPLIANCE**  
(Pursuant to Section 53 of the *Environmental Management Act*)

**THIS IS TO CERTIFY** that as of the date indicated below, the site identified in Schedule A of this Certificate of Compliance has been satisfactorily remediated to meet the applicable Contaminated Sites Regulation remediation standards and criteria.

This Certificate of Compliance is qualified by the requirements and conditions specified in Schedule B.

The substances for which remediation has been satisfactorily completed and for which this Certificate of Compliance is valid are listed in Schedule C.

I have issued this Certificate of Compliance based on a review of relevant information including the documents listed in Schedule D. I, however, make no representation or warranty as to the accuracy or completeness of that information.

A Director may rescind this Certificate of Compliance if requirements and conditions imposed in the Certificate of Compliance are not complied with or any fees payable under Part 4 of the Act or regulations are outstanding.

This Certificate of Compliance should not be construed as an assurance that there are no hazards present at the site.

The substances to which this Certificate of Compliance applies migrated to the site from a neighbouring source. It should not be assumed that this Certificate of Compliance certifies the remediation of all contaminants at the site.

January 9, 2018  
Date Issued

  
Lavinia Zanini, P.Ge.  
For Director, *Environmental Management Act*

## Schedule A

The site covered by this Certificate of Compliance is located at 1835 Kingsway, Avenue, Port Coquitlam, British Columbia, which is more particularly known as:

Portion of 004-676-963, Lot 12 District Lot 382 Group 1 New Westminster District Plan 10150  
Except: Plan BCP39472 described by the following metes and bounds:

Starting at the southwest corner of Lot 12 at Area #1 Starting Point, of Posting Plan of Lots 13 And 14 of District Lots 382, 463 And 480, and Lot 15 of District Lot 382 and 463, all of Group 1 New Westminster District, Plan 10150:

Thence 32° 46' 17" for 21.605 metres;  
to the Point of Commencement.

Thence 32° 46' 17" for 26.989 metres;  
Thence 122° 46' 17" for 74.199 metres;  
Thence 212° 46' 17" for 8.409 metres;  
Thence 164° 36' 47" for 100.301 metres;  
Thence 212° 46' 17" for 151.672 metres;  
Thence 302° 46' 17" for 148.922 metres;

Returning to the Point of Commencement.

The site contains part of a legal parcel depicted in an engineering drawing prepared by Keystone Environmental Ltd. on September 2017.

The approximate centre of the site using the NAD (North American Datum) 1983 convention is:

Latitude: 49° 15' 18.0"  
Longitude: 122° 45' 49.2"

January 9, 2018  
Date Issued

  
Lavinia Zanini, P.Geo.  
For Director, *Environmental Management Act*

## Site Plan, Port Coquitlam, BC

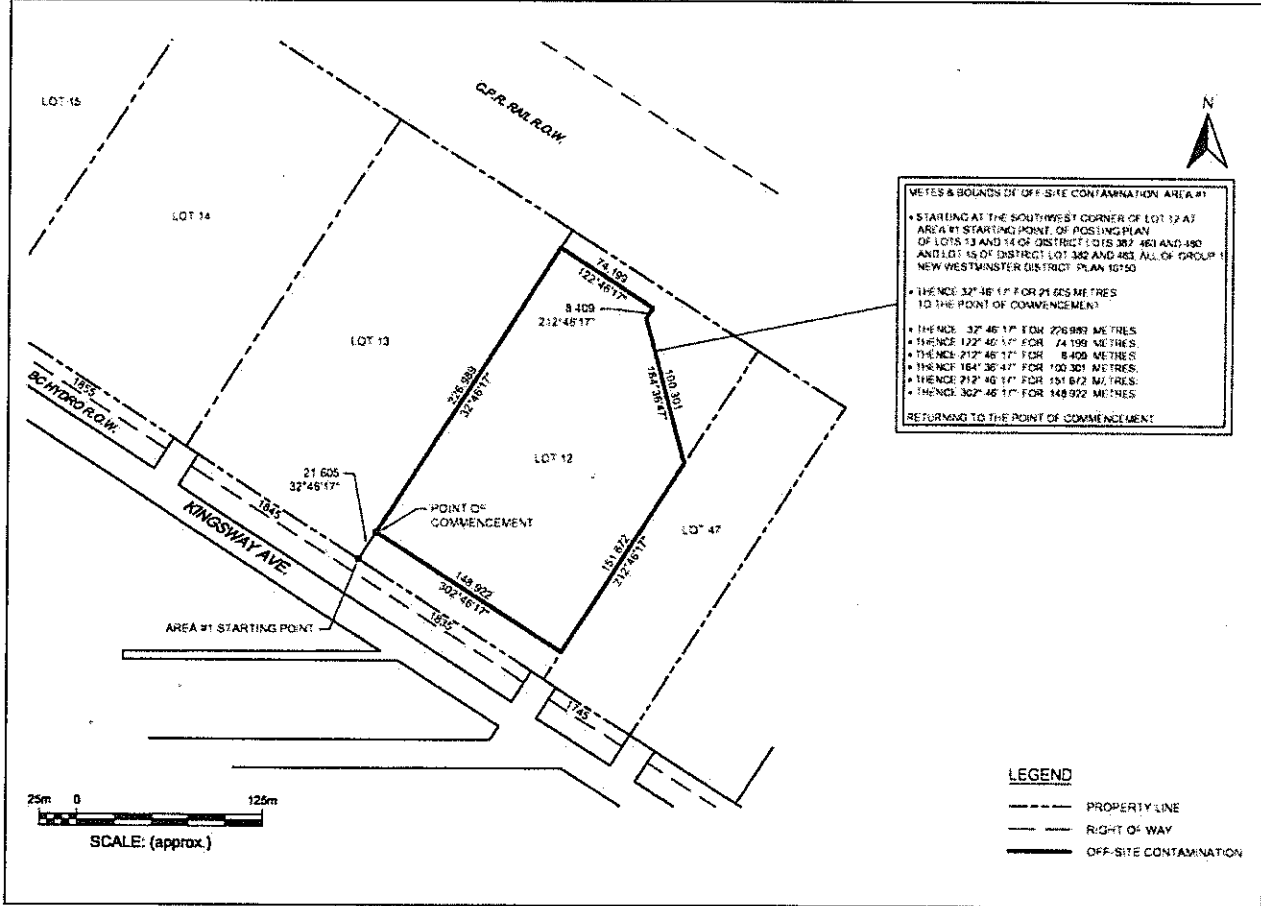

## Location Map, Port Coquitlam, BC

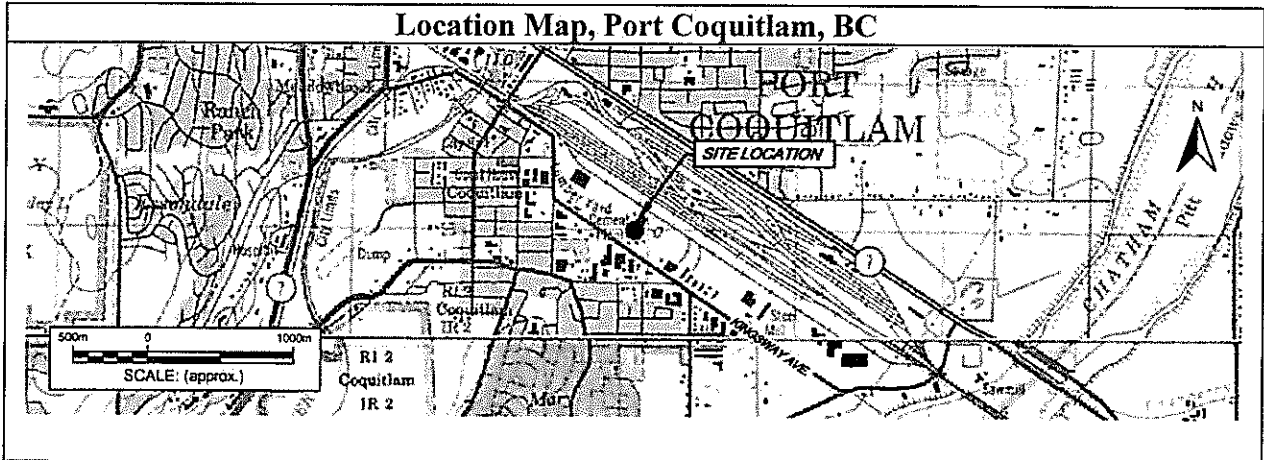

January 9, 2018

Date Issued

Lavinia Zanini, P.Geo.  
 For Director, *Environmental Management Act*

## Schedule B

### Requirements and Conditions

1. Any changes in water use must be promptly identified by the responsible persons in a written submission to the Director. An application for an amendment or new Certificate of Compliance may be necessary. The uses to which this condition applies are described in Schedule C and in the site investigation documents listed in Schedule D.
2. The principal risk controls which must be present or implemented and must be maintained at the site include the following:
  - (a) Site groundwater must not be used as a source of drinking water.
3. If requested by the Director, the responsible person must provide a signed statement indicating whether the principal risk controls listed in clause 2 of this Schedule have been and continue to be met. This may include providing a signed statement by an Approved Professional.
4. The Director must be notified promptly by the person responsible for the site if any institutional and engineering controls required in clause 2 of this Schedule are not being met. The following information must be submitted to the Director with the notification, or as soon as practicable thereafter:
  - (a) The time period over which institutional and engineering controls did not meet the requirements of Schedule B;
  - (b) The nature of the excursion;
  - (c) The temporary or permanent corrective measures implemented or to be implemented;
  - (d) An implementation schedule; and
  - (e) Supporting documentation.

January 9, 2018  
Date Issued

---

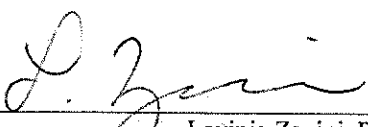
  
Lavinia Zanini, P.Ge.  
For Director, *Environmental Management Act*

## Schedule C

### Substances and Uses

#### *Substances remediated in water for drinking water use:*

##### To meet risk-based remediation standards:

- Aluminum, arsenic, cadmium, molybdenum, selenium, and sodium.

#### *Substances remediated in water for freshwater aquatic life use:*

##### To meet risk-based remediation standards:

- Arsenic, cadmium, and selenium; and
- Nonchlorinated phenols (total).

January 9, 2018

Date Issued

  
Lavinia Zanini, P. Geo.  
For Director, *Environmental Management Act*

## Schedule D

### Documents

*Summary of Site Condition 1835 Kingsway Avenue, Port Coquitlam, BC, Keystone Environmental Ltd., dated September 11, 2017;*

*Report of Findings – Preliminary Site Investigation – Stage 1 and Stage 2, and Detailed Site Investigation, 1845, 1855 and 1925 Kingsway Avenue, Port Coquitlam, BC, Keystone Environmental Ltd., dated September 2017;*

*Performance Verification Plan for Certificate of Compliance, 1845, 1855, and 1925 Kingsway Avenue, Port Coquitlam, BC, Keystone Environmental Ltd., dated September 2017;*

*Report of Findings – Human Health and Ecological Risk Assessment, 1845, 1855, and 1925 Kingsway Avenue, Port Coquitlam, BC, Keystone Environmental Ltd., dated September 2017;*

*Administrative Guidance 11 Communication Record – 1745 Kingsway Avenue, Port Coquitlam, BC, Keystone Environmental Ltd., dated September 2017;*

*Landfill Monitoring Report for 2015-2016 – 1845, 1855, and 1925 Kingsway, Port Coquitlam, BC, Keystone Environmental Ltd., dated March 2016;*

*2014-2015 Ground and Surface Water Monitoring Report – ESCO Foundry Landfill, AECOM Canada Ltd., dated March 2015;*

*2013-2014 Ground and Surface Water Monitoring Report – ESCO Foundry Landfill, AECOM Canada Ltd., dated March 2014;*

*2011-2012 Ground and Surface Water Monitoring Report – ESCO Foundry Landfill, AECOM Canada Ltd., dated March 2012;*

*2010-2011 Ground and Surface Water Monitoring Report – ESCO Foundry Landfill, AECOM Canada Ltd., dated March 2011;*

*2009-2010 Ground and Surface Water Monitoring Report – ESCO Foundry Landfill, AECOM Canada Ltd., dated March 2010;*

*2008-2009 Ground and Surface Water Monitoring Report – ESCO Foundry Landfill, AECOM Canada Ltd., dated March 2009;*

January 9, 2018

Date Issued

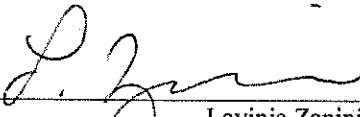
  
Lavinia Zanini, P. Geo.  
For Director, *Environmental Management Act*

DRAFT 2007-2008 *Ground and Surface Water Monitoring Report – ESCO Foundry Landfill*, Gartner Lee Limited, dated March 2008;

2006–2007 *Ground and Surface Water Monitoring Report – ESCO Foundry Landfill*, Gartner Lee Limited, dated March 2007; and

*Final Phase I Environmental Site Assessment, ESCO Corporation, 1855 Kingsway Avenue, Port Coquitlam, BC*, ERM Canada Corp., dated October 2006.

January 9, 2018

Date Issued

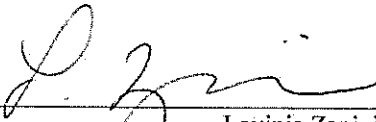
  
Lavinia Zanini, P. Geo.  
For Director, *Environmental Management Act*